



OWNER'S MANUAL

**⚠ Read this manual carefully
before operating this vehicle.**

FINN

MOTORCYCLE

T115FL-2C / T115FL-5C / T115FL-5CF

Location of important labels	1
Safety information	2
Description	3
Smart key system	4
Instrument and control functions	5
For your safety – pre-operation checks	6
Operation and important riding points	7
Periodic maintenance and adjustment	8
Motorcycle care and storage	9
Specifications	10
Consumer information	11
Index	12

DA6-F8199-E0



เครื่องโทรคมนาคมและอุปกรณ์นี้ มีความสอดคล้องตาม
มาตรฐานหรือข้อกำหนดทางเทคนิคของ กสทช.

 **Read this manual carefully before operating this vehicle. This manual should stay with this vehicle if it is sold.**

Welcome to the Yamaha world of motorcycling!

As the owner of the T115FL-2C / T115FL-5C / T115FL-5CF, you are benefiting from Yamaha's vast experience and newest technology regarding the design and manufacture of high-quality products, which have earned Yamaha a reputation for dependability.

Please take the time to read this manual thoroughly, so as to enjoy all advantages of your T115FL-2C / T115FL-5C / T115FL-5CF. The Owner's Manual does not only instruct you in how to operate, inspect and maintain your motorcycle, but also in how to safeguard yourself and others from trouble and injury.

In addition, the many tips given in this manual will help keep your motorcycle in the best possible condition. If you have any further questions, do not hesitate to contact your Yamaha dealer.

The Yamaha team wishes you many safe and pleasant rides. So, remember to put safety first!

Yamaha continually seeks advancements in product design and quality. Therefore, while this manual contains the most current product information available at the time of printing, there may be minor discrepancies between your motorcycle and this manual. If there is any question concerning this manual, please consult a Yamaha dealer.





Please read this manual carefully and completely before operating this motorcycle.

Important manual information

EAU10134

Particularly important information is distinguished in this manual by the following notations:

	This is the safety alert symbol. It is used to alert you to potential personal injury hazards. Obey all safety messages that follow this symbol to avoid possible injury or death.
	A WARNING indicates a hazardous situation which, if not avoided, could result in death or serious injury.
NOTICE	A NOTICE indicates special precautions that must be taken to avoid damage to the vehicle or other property.
TIP	A TIP provides key information to make procedures easier or clearer.

*Product and specifications are subject to change without notice.

EAU37432

**T115FL-2C / T115FL-5C / T115FL-5CF
OWNER'S MANUAL**

**©2026 by Thai Yamaha Motor Co., Ltd.
1st edition, January 2026
All rights reserved.**

**Any reprinting or unauthorized use
without the written permission of
Thai Yamaha Motor Co., Ltd.
is expressly prohibited.
Printed in Thailand.**

Table of contents

Location of important labels	1-1	Kickstarter (T115FL-2C / T115FL-5C).....	5-14	Checking the spark plug.....	8-7
Safety information	2-1	Seat (T115FL-2C/T115FL-5C).....	5-14	Engine oil and oil filter element.....	8-9
Further safe-riding points	2-5	Helmet holders.....	5-15	Why Yamalube.....	8-11
Helmets	2-6	Storage compartments	5-15	Replacing the air filter element and cleaning the check hoses...	8-11
Description	3-1	Luggage hook	5-17	Adjusting the engine idling speed	8-12
Left view	3-1	Power outlet	5-17	Adjusting the throttle grip free play.....	8-13
Right view	3-2	Sidestand	5-18	Valve clearance.....	8-14
Controls and instruments	3-3	For your safety – pre-operation checks	6-1	Tires.....	8-14
Smart key system (T115FL-5CF)	4-1	Operation and important riding points	7-1	Wheels	8-16
Smart key system.....	4-1	Engine break-in.....	7-1	Checking the brake lever free play.....	8-16
Instrument and control functions	5-1	Starting and warming up a cold engine	7-2	Adjusting the brake pedal free play.....	8-17
Main switch (T115FL-5CF)	5-1	Shifting	7-3	Brake light switches	8-17
Main switch/steering lock (T115FL-2C / T115FL-5C).....	5-4	Tips for reducing fuel consumption.....	7-4	Checking the front brake pads and rear brake shoes	8-18
Keyhole cover.....	5-5	Parking	7-4	Checking the brake fluid level	8-19
Indicator lights and warning lights.....	5-6	Periodic maintenance and adjustment	8-1	Changing the brake fluid	8-19
Multi-function meter unit	5-7	Tool kit	8-1	Drive chain slack.....	8-20
Handlebar switches.....	5-10	Periodic maintenance chart for the emission control system.....	8-2	Cleaning and lubricating the drive chain.....	8-21
Shift pedal	5-10	General maintenance and lubrication chart.....	8-3	Checking and lubricating the cables.....	8-22
Brake lever.....	5-11	Removing and installing the panel.....	8-7	Checking and lubricating the throttle grip and cable end.....	8-22
Brake pedal	5-11			Checking and lubricating the brake lever.....	8-22
Fuel tank cap	5-12				
Fuel.....	5-12				
Catalytic converter	5-13				

Table of contents

Checking and lubricating the brake pedal	8-23
Checking and lubricating the centerstand and sidestand	8-23
Lubricating the swingarm pivots ...	8-24
Checking the front fork.....	8-24
Checking the steering	8-25
Checking the wheel bearings	8-25
Battery	8-25
Replacing the fuse.....	8-27
Headlight	8-28
Auxiliary light bulb	8-28
Front/rear turn signal light and tail/brake light	8-28
Troubleshooting	8-29
Troubleshooting chart	8-30
Emergency mode (T115FL-5CF) ...	8-31
Motorcycle care and storage	9-1
Matte color caution	9-1
Care	9-1
Storage.....	9-3
Specifications	10-1
Consumer information	11-1
Identification numbers.....	11-1
Use of your data	11-2
Index	12-1

Location of important labels

EAU10387

1

Read and understand all of the labels on your vehicle. They contain important information for safe and proper operation of your vehicle. Never remove any labels from your vehicle. If a label becomes difficult to read or comes off, a replacement label is available from your Yamaha dealer.

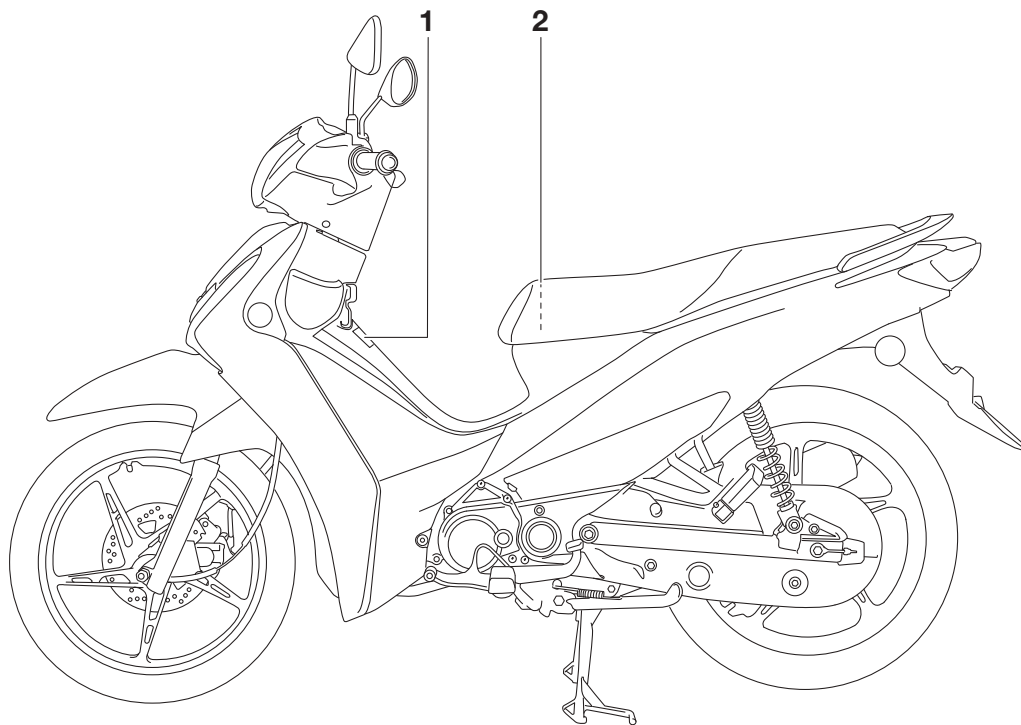

1

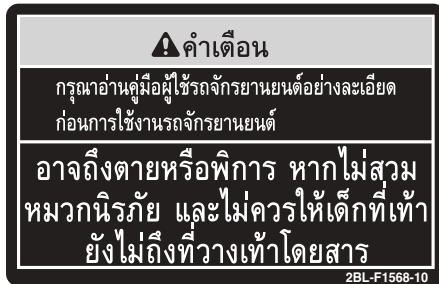

2

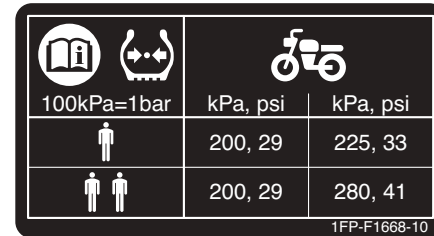

EAUU1072

2 Be a Responsible Owner

As the vehicle's owner, you are responsible for the safe and proper operation of your motorcycle.

Motorcycles are single-track vehicles. Their safe use and operation are dependent upon the use of proper riding techniques as well as the expertise of the operator. Every operator should know the following requirements before riding this motorcycle.

He or she should:

- Obtain thorough instructions from a competent source on all aspects of motorcycle operation.
- Observe the warnings and maintenance requirements in this Owner's Manual.
- Obtain qualified training in safe and proper riding techniques.
- Obtain professional technical service as indicated in this Owner's Manual and/or when made necessary by mechanical conditions.

Safe Riding

Perform the pre-operation checks each time you use the vehicle to make sure it is in safe operating condition. Failure to inspect or maintain the vehicle properly increases the possibility of an accident or equipment damage. See page 6-1 for a list of pre-operation checks.

- This motorcycle is designed to carry the operator and a passenger.

TIP

Although this motorcycle is designed to carry a passenger, always comply with the local regulations.

- The failure of motorists to detect and recognize motorcycles in traffic is the predominating cause of automobile/motorcycle accidents. Many accidents have been caused by an automobile driver who did not see the motorcycle. Making yourself conspicuous ap-

pears to be very effective in reducing the chance of this type of accident.

Therefore:

- Wear a brightly colored jacket.
- Use extra caution when you are approaching and passing through intersections, since intersections are the most likely places for motorcycle accidents to occur.
- Ride where other motorists can see you. Avoid riding in another motorist's blind spot.
- Many accidents involve inexperienced operators. In fact, many operators who have been involved in accidents do not even have a current driver's license.
- Make sure that you are qualified and that you only lend your motorcycle to other qualified operators.
- Know your skills and limits. Staying within your limits may help you to avoid an accident.
- We recommend that you practice riding your motorcycle where there is no traffic until you

have become thoroughly familiar with the motorcycle and all of its controls.

- Many accidents have been caused by error of the motorcycle operator. A typical error made by the operator is veering wide on a turn due to excessive speed or undercornering (insufficient lean angle for the speed).
 - Always obey the speed limit and never travel faster than warranted by road and traffic conditions.
 - Always signal before turning or changing lanes. Make sure that other motorists can see you.
- The posture of the operator and passenger is important for proper control.
 - The operator should keep both hands on the handlebar and both feet on the operator footrests during operation to maintain control of the motorcycle.
 - The passenger should always hold onto the operator, the seat strap or grab bar, if equipped, with both hands and keep both

feet on the passenger footrests. Never carry a passenger unless he or she can firmly place both feet on the passenger footrests.

- Never ride under the influence of alcohol or other drugs.
- This motorcycle is designed for on-road use only. It is not suitable for off-road use.

Protective Apparel

The majority of fatalities from motorcycle accidents are the result of head injuries. The use of a safety helmet is the single most critical factor in the prevention or reduction of head injuries.

- Always wear an approved helmet.
- Wear a face shield or goggles. Wind in your unprotected eyes could contribute to an impairment of vision that could delay seeing a hazard.
- The use of a jacket, substantial shoes, trousers, gloves, etc., is effective in preventing or reducing abrasions or lacerations.

- Never wear loose-fitting clothes, otherwise they could catch on the control levers or wheels and cause injury or an accident.
- Always wear protective clothing that covers your legs, ankles, and feet. The engine or exhaust system become very hot during or after operation and can cause burns.
- A passenger should also observe the above precautions.

Avoid Carbon Monoxide Poisoning

All engine exhaust contains carbon monoxide, a deadly gas. Breathing carbon monoxide can cause headaches, dizziness, drowsiness, nausea, confusion, and eventually death. Carbon Monoxide is a colorless, odorless, tasteless gas which may be present even if you do not see or smell any engine exhaust. Deadly levels of carbon monoxide can collect rapidly and you can quickly be overcome and unable to save yourself. Also, deadly levels of carbon monoxide can linger for hours or days in enclosed or poorly ventilated areas. If you experience any

Safety information

2

symptoms of carbon monoxide poisoning, leave the area immediately, get fresh air, and SEEK MEDICAL TREATMENT.

- Do not run engine indoors. Even if you try to ventilate engine exhaust with fans or open windows and doors, carbon monoxide can rapidly reach dangerous levels.
- Do not run engine in poorly ventilated or partially enclosed areas such as barns, garages, or carports.
- Do not run engine outdoors where engine exhaust can be drawn into a building through openings such as windows and doors.

Loading

Adding accessories or cargo to your motorcycle can adversely affect stability and handling if the weight distribution of the motorcycle is changed. To avoid the possibility of an accident, use extreme caution when adding cargo or accessories to your motorcycle. Use extra care when riding a motorcycle that has added cargo or accessories. Here, along with the information about

accessories below, are some general guidelines to follow if loading cargo to your motorcycle:

The total weight of the operator, passenger, accessories and cargo must not exceed the maximum load limit.

Operation of an overloaded vehicle could cause an accident.

Maximum load:

154 kg (340 lb) (T115FL-2C,
T115FL-5CF)
155 kg (342 lb) (T115FL-5C)

When loading within this weight limit, keep the following in mind:

- Cargo and accessory weight should be kept as low and close to the motorcycle as possible. Securely pack your heaviest items as close to the center of the vehicle as possible and make sure to distribute the weight as evenly as possible on both sides of the motorcycle to minimize imbalance or instability.
- Shifting weights can create a sudden imbalance. Make sure that accessories and cargo are securely attached to the motorcycle

before riding. Check accessory mounts and cargo restraints frequently.

- Properly adjust the suspension for your load (suspension-adjustable models only), and check the condition and pressure of your tires.
- Never attach any large or heavy items to the handlebar, front fork, or front fender. Such items can create unstable handling or a slow steering response.
- **This vehicle is not designed to pull a trailer or to be attached to a sidecar.**

Genuine Yamaha Accessories

Choosing accessories for your vehicle is an important decision. Genuine Yamaha accessories, which are available only from a Yamaha dealer, have been designed, tested, and approved by Yamaha for use on your vehicle.

Many companies with no connection to Yamaha manufacture parts and accessories or offer other modifications for Yamaha vehicles. Yamaha is not in a position to test the products that

these aftermarket companies produce. Therefore, Yamaha can neither endorse nor recommend the use of accessories not sold by Yamaha or modifications not specifically recommended by Yamaha, even if sold and installed by a Yamaha dealer.

Aftermarket Parts, Accessories, and Modifications

While you may find aftermarket products similar in design and quality to genuine Yamaha accessories, recognize that some aftermarket accessories or modifications are not suitable because of potential safety hazards to you or others. Installing aftermarket products or having other modifications performed to your vehicle that change any of the vehicle's design or operation characteristics can put you and others at greater risk of serious injury or death. You are responsible for injuries related to changes in the vehicle. Keep the following guidelines in mind, as well as those provided under "Loading" when mounting accessories.

- Never install accessories or carry cargo that would impair the performance of your motorcycle. Carefully inspect the accessory before using it to make sure that it does not in any way reduce ground clearance or cornering clearance, limit suspension travel, steering travel or control operation, or obscure lights or reflectors.
- Accessories fitted to the handlebar or the front fork area can create instability due to improper weight distribution or aerodynamic changes. If accessories are added to the handlebar or front fork area, they must be as lightweight as possible and should be kept to a minimum.
- Bulky or large accessories may seriously affect the stability of the motorcycle due to aerodynamic effects. Wind may attempt to lift the motorcycle, or the motorcycle may become unstable in cross winds. These

accessories may also cause instability when passing or being passed by large vehicles.

- Certain accessories can displace the operator from his or her normal riding position. This improper position limits the freedom of movement of the operator and may limit control ability, therefore, such accessories are not recommended.
- Use caution when adding electrical accessories. If electrical accessories exceed the capacity of the motorcycle's electrical system, an electric failure could result, which could cause a dangerous loss of lights or engine power.

Aftermarket Tires and Rims

The tires and rims that came with your motorcycle were designed to match the performance capabilities and to provide the best combination of handling, braking, and comfort. Other tires, rims, sizes, and combinations

Safety information

may not be appropriate. Refer to page 8-14 for tire specifications and more information on replacing your tires.

2

Transporting the Motorcycle

Be sure to observe following instructions before transporting the motorcycle in another vehicle.

- Remove all loose items from the motorcycle.
- Point the front wheel straight ahead on the trailer or in the truck bed, and choke it in a rail to prevent movement.
- Secure the motorcycle with tie-downs or suitable straps that are attached to solid parts of the motorcycle, such as the frame or upper front fork triple clamp (and not, for example, to rubber-mounted handlebars or turn signals, or parts that could break). Choose the location for the straps carefully so the straps will not rub against painted surfaces during transport.
- The suspension should be compressed somewhat by the tie-downs, if possible, so that the motorcycle will not bounce excessively during transport.

EAU57610

Further safe-riding points

- Be sure to signal clearly when making turns.
- Braking can be extremely difficult on a wet road. Avoid hard braking, because the motorcycle could slide. Apply the brakes slowly when stopping on a wet surface.
- Slow down as you approach a corner or turn. Once you have completed a turn, accelerate slowly.
- Be careful when passing parked cars. A driver might not see you and open a door in your path.
- Railroad crossings, streetcar rails, iron plates on road construction sites, and manhole covers become extremely slippery when wet. Slow down and cross them with caution. Keep the motorcycle upright, otherwise it could slide out from under you.
- The brake pads or linings could get wet when you wash the motorcycle. After washing the motorcycle, check the brakes before riding.

- Always wear a helmet, gloves, trousers (tapered around the cuff and ankle so they do not flap), and a brightly colored jacket.
- Do not carry too much luggage on the motorcycle. An overloaded motorcycle is unstable. Use a strong cord to secure any luggage to the carrier (if equipped). A loose load will affect the stability of the motorcycle and could divert your attention from the road. (See page 2-3.)

Helmets

EAUU0033

Operating this vehicle without an approved motorcycle helmet increases your chances of a severe head injury or death in the event of an accident. The majority of fatalities from motorcycle or scooter accidents are the result of head injuries. The use of a safety helmet is the single most critical factor in the prevention or reduction of head injuries.

Always select an approved motorcycle helmet

Pay attention to the following when choosing a motorcycle helmet.

- The helmet must meet the safety standard “TIS”.
- The helmet size must match the size of the rider’s head.
- Never subject a helmet to heavy shocks.

Wearing the helmet correctly

Always connect the chin strap. In the case of an accident, the helmet has a much less chance of coming off if the chin strap is connected.

Correct usage



ZAAU0003

Wrong usage



ZAAU0007

Types of helmets and their usage

- Half-type: use only for riding at low speeds

Safety information

2

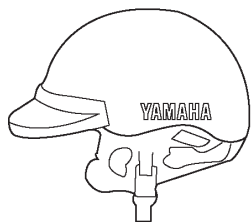

ZAUU0004

- Full-type: use only for riding at low to mid-range speeds

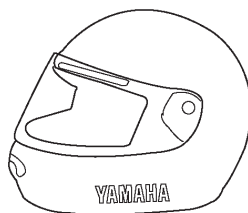

ZAUU0006



ZAUU0005

- Full-face-type: use for riding at mid-range to high speeds

Left view

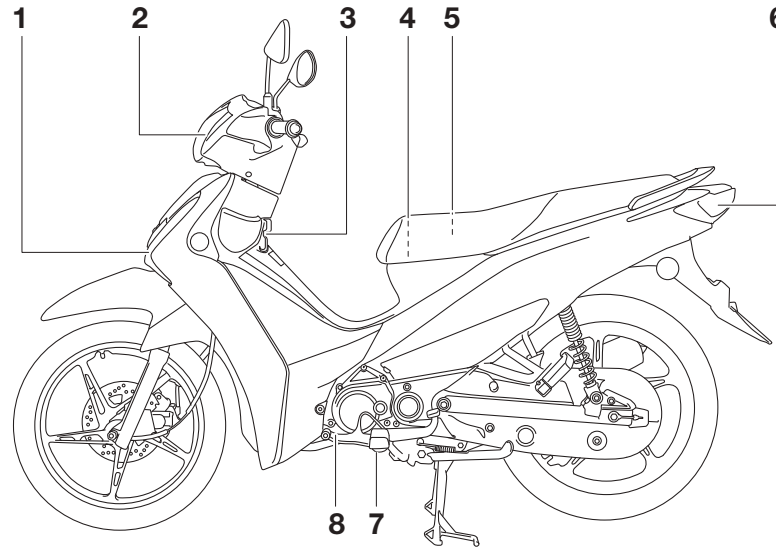

1. Front turn signal light (page 8-28)
2. Headlight (page 8-28)
3. Luggage hook (page 5-17)
4. Helmet holder (page 5-15)
5. Tool kit (page 8-1)
6. Tail/brake/turn signal light (page 8-28)
7. Engine oil drain bolt (page 8-9)
8. Shift pedal (page 5-10)

Description

EAU10421

Right view

3

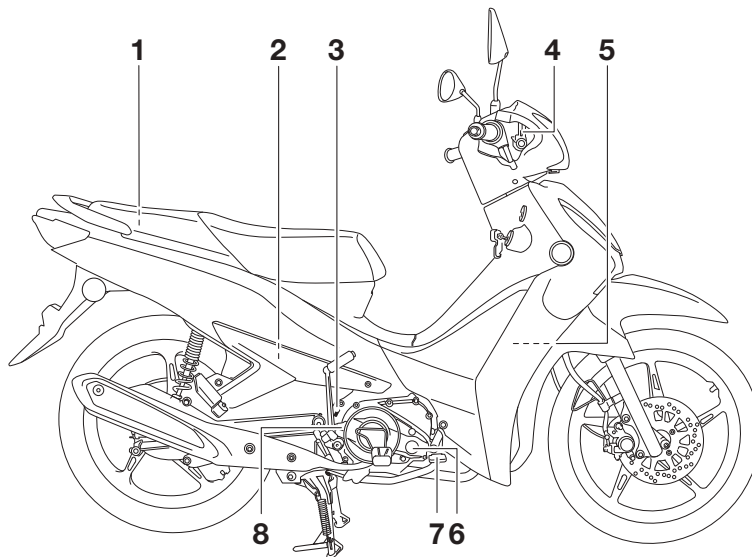

1. Fuel tank cap (page 5-12)
2. Battery (page 8-25)
3. Rear brake light switch (page 8-17)
4. Front brake fluid reservoir (page 8-19)
5. Air filter (page 8-11)
6. Engine oil filter element (page 8-9)
7. Brake pedal (page 5-11)
8. Engine oil filler cap (page 8-9)

Controls and instruments

T115FL-2C / T115FL-5C

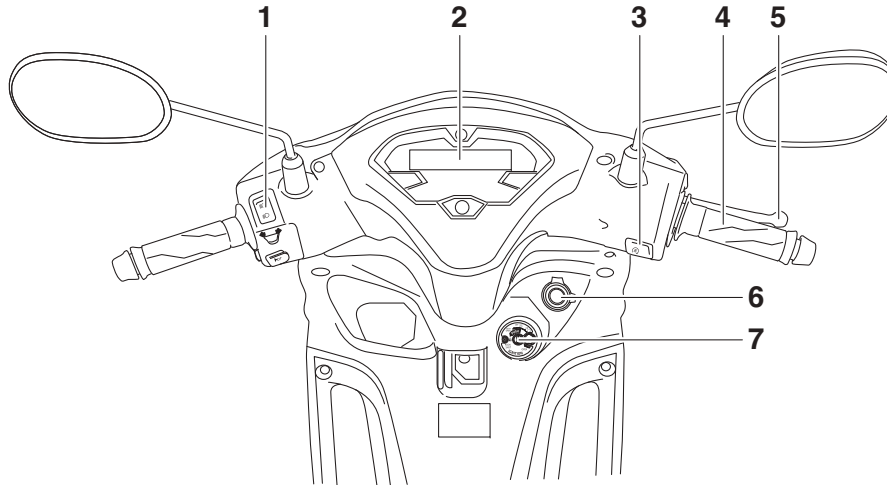

1. Left handlebar switches (page 5-10)
2. Multi-function meter unit (page 5-7)
3. Right handlebar switch (page 5-10)
4. Throttle grip (page 8-13)
5. Front brake lever (page 5-11)
6. Power outlet (page 5-17)
7. Main switch/steering lock (page 5-4/5-1)

Description

T115FL-5CF

3

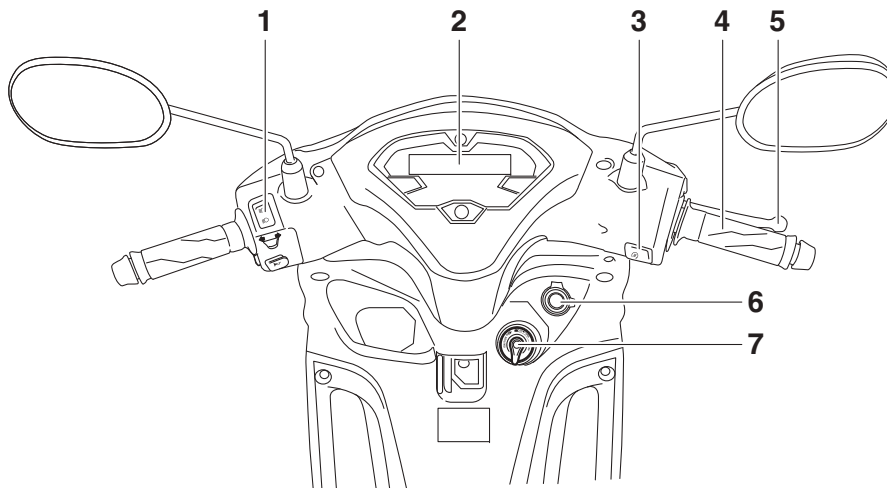

1. Left handlebar switches (page 5-10)
2. Multi-function meter unit (page 5-7)
3. Right handlebar switches (page 5-10)
4. Throttle grip (page 8-13)
5. Front brake lever (page 5-11)
6. Power outlet (page 5-17)
7. Main switch (page 5-4/5-1)

Smart key system

The smart key system enables you to operate the vehicle without using a mechanical key.

EAU99231

EAUJ2551

Included with the vehicle is one smart key and one identification number card.

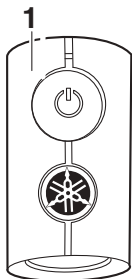

1. Smart key

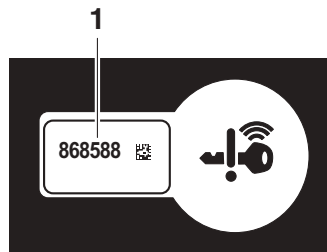

1. Identification number card

EWA22271

! WARNING

● **KEEP OUT OF REACH OF CHILDREN**

The smart key contains a coin/button cell battery.

- **Swallowing can lead to chemical burns, perforation of soft tissue, and death. Severe burns can occur within 2 hours of ingestion. Seek medical attention immediately.**

TIP

- You can register up to six smart keys for the same vehicle. See a Yamaha dealer regarding spare smart keys.
- If a smart key is lost, contact a Yamaha dealer immediately to prevent the vehicle from being stolen.

If the smart key is lost or the smart key battery has discharged, the identification number can be used to operate the vehicle in emergency mode. (See page 8-31.) **Write down the identification number in case of emergency.**

If the smart key(s) and identification number card(s) are all lost or damaged, and there is no record of the identification number, the entire smart key system will need to be replaced.

Smart key system (T115FL-5CF)

4

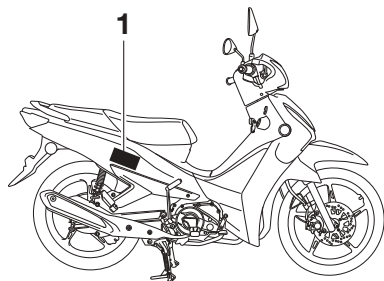

1. Vehicle mounted antenna

EWA14704

WARNING

- Keep implanted pacemakers or cardiac defibrillators, as well as other electric medical devices away from the vehicle mounted antenna (see illustration).
- Radio waves transmitted by the antenna may affect the operation of such devices when close by.
- If you have an electric medical device, consult a doctor or the device manufacturer before using this vehicle.

Operating range of the smart key system

The approximate operating range of the smart key system is shown below.

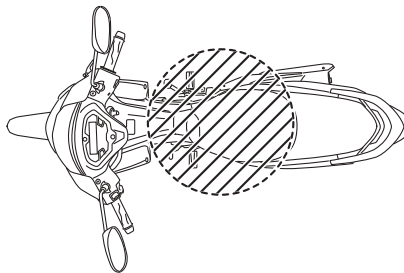
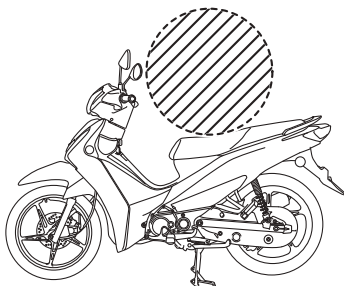

ECA29030

NOTICE

- The smart key should be carried with you. Do not store it on the vehicle.

- When the smart key is within operating range, exercise due care because other people not carrying the smart key can start the engine and operate the vehicle.

If the smart key is turned off, the vehicle will not recognize the smart key even if it is within operating range. If the smart key battery is discharged, the smart key system may not work or its operating range may become very short.

TIP

- Do not place the smart key in a storage compartment.
- Always carry the smart key with you.
- Turn the smart key off when leaving the vehicle.
- The smart key system uses weak radio waves. The smart key system may not work in the following situations:
 - The smart key is placed in a location exposed to strong radio waves or other electromagnetic noise

- There are facilities nearby that are emitting strong radio waves (TV or radio towers, power plants, broadcasting stations, airports, etc.)
 - You are carrying or using communication equipment such as radios or mobile phones in close proximity of the smart key
 - The smart key is in contact with or covered by a metallic object
 - Other vehicles equipped with a smart key system are nearby
- In such situations, move the smart key to another location and perform the operation again. If it still does not work, operate the vehicle in emergency mode. (See page 8-31.)
- To preserve vehicle battery power, the smart key system turns off approximately 9 days after the vehicle was last used. In this situation, simply push the main switch knob to turn the smart key system back on.

NOTICE

The smart key has precision electronic components. Observe the following precautions to prevent possible malfunction or damage.

- Do not place or store the smart key in a storage compartment. The smart key may be damaged from road vibrations or excessive heat.
- Do not drop, bend, or subject the smart key to strong impacts.
- Do not submerge the smart key in water or other liquids.
- Do not place heavy items or excessive stress on the smart key.
- Do not leave the smart key in a place exposed to direct sunlight, high temperature or high humidity.
- Do not grind or attempt to modify the smart key.
- Keep the smart key away from strong magnetic fields and magnetic objects such as key holders, TVs, and computers.
- Keep the smart key away from electric medical equipment.

ECA21573

- Do not allow oils, polishing agents, fuel, or any strong chemicals to come in contact with the smart key. The smart key body may become discolored or cracked.

Using the smart key

EUA8710

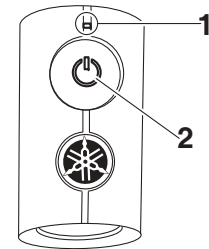

1. Smart key indicator light
2. Smart key button

When the smart key is turned on and brought within range, the smart key system allows you to operate the vehicle without inserting a mechanical key. If the smart key is turned off, the vehicle cannot be operated even if the smart key is within operating range of the vehicle.

Smart key system (T115FL-5CF)

The current status of the key can be checked by briefly pressing the smart key button.

- Short flash: the key is on
- Long flash: the key is off

To turn the smart key on or off

To turn the smart key on or off, press the smart key button for one second. The smart key indicator light will flash. If the key does a short flash, the key is on. If the key does a long flash, the key is off.

EAUJ8560

Remote answer-back function

The smart key system is equipped with an answer-back function to help you locate the vehicle in parking lots.

Push the smart key button to operate the answer-back function remotely. The beeper will sound twice and all of the turn signal lights will flash twice. This feature is convenient for locating your vehicle in parking lots and other areas.

Operating range of the answer-back function

The approximate operating range of the answer-back function is as shown.

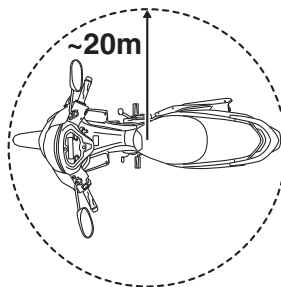

As the smart key system uses weak radio waves, the operating range may be affected by the surrounding environment.

To turn the answer-back beeper on or off

The beeper, which sounds when the answer-back function is operated, can be turned on or off according to the following procedure.

1. Turn the smart key on and bring it within operating range.

2. Turn the main switch to “OFF”, and then push the main switch knob once.
3. Within 9 seconds of pushing the knob, push and hold the knob again for 5 seconds.
4. When the beeper sounds, the setting is complete.

If the beeper:

- Sounds twice: The beeper is turned off.
- Sounds once: The beeper is turned on.

TIP

If the answer-back function does not operate when the smart key button is pressed, the smart key battery may need to be changed.

EAUJ603

Smart key battery

Replace the smart key battery if any of the following occur:

- The smart key system indicator light (page 5-6) flashes for about 20 seconds when the vehicle power is turned on.

Smart key system (T115FL-5CF)

- The smart key indicator light does not flash when the smart key button is pressed.

Specified battery:
CR2032
Nominal voltage:
3 V

EWA22830

WARNING

This battery contains combustible materials such as lithium metal and organic electrolyte. The following cautions should be followed in order to use this battery safely:

- Do not short circuit the battery
- Do not charge the battery
- Do not soak the battery in water
- Do not deform or damage the battery
- Do not modify the battery in any way

TIP

- The smart key battery life is approximately two years, but this may vary according to operating conditions.

- The smart key battery may become discharged even if it is away from the vehicle and not being used.
- If the smart key continually receives radio waves, the smart key battery will discharge quickly. (For example, when placed in the vicinity of electrical products such as televisions, radios, or computers.)
- After changing the smart key battery, if the smart key system still does not operate, have a Yamaha dealer check the vehicle.

To replace the smart key battery

1. Gently pry open the smart key case as shown. Otherwise, have a Yamaha dealer replace the battery.

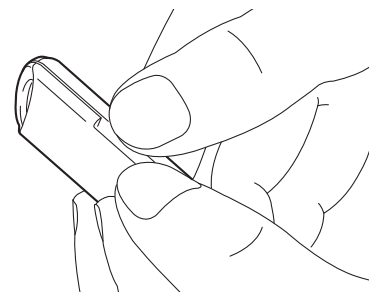

2. Remove the battery.

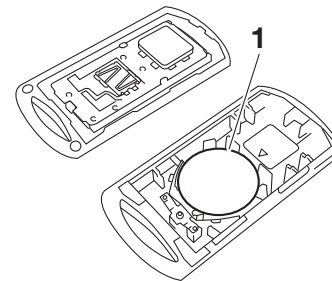

1. Battery

TIP

Dispose of the removed battery in accordance with local regulations.

3. Note the polarity of the battery and install it with the positive "+" side facing downwards as shown.

Smart key system (T115FL-5CF)

4

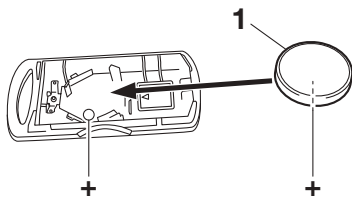

1. Battery

4. Gently snap the smart key case closed.

ECA15785

NOTICE

- Use a cloth when opening the smart key case with a screwdriver. Direct contact with hard objects may damage or scratch the smart key.
- Take precautions to prevent the waterproof seal from being damaged or contaminated by dirt.
- Do not touch the internal circuits and terminals. This may cause malfunctions.

- Do not apply excessive force to the smart key when replacing the battery.
- Make sure the battery is installed correctly. Confirm the direction of the positive “+” side of the battery.

 : This symbol is intended to alert the user to the presence of important operating and maintenance (servicing) instructions in the literature accompanying the appliance.

EWA20633

WARNING

This product contains a coin/button cell battery.

To prevent an explosion or leakage of flammable liquid or gas:

- Do not replace the battery with an incorrect type. Replace only with the same or equivalent type.
- Please check and obey all local laws and regulations for the disposal of batteries or accumulations.

- Do not dispose of any battery with fire, incineration, or by mechanically crushing or cutting the battery.
- Do not store, or put a smart key any place where it may be exposed to extremely high temperatures or extremely low air pressure.
- If a battery is incorrectly discarded or heated to a high temperature (100 °C (212 °F) or higher), gas may be generated inside battery thereby causing electrolyte leakage, internal short circuit, heat generation, explosion and violent flaring.
- Do not expose smart keys to excessive heat such as direct sunlight, fire, etc.

Do not swallow any coin/button cell batteries:

- Do not ingest the battery, chemical burn hazard.

- If the coin/button cell battery is swallowed or placed inside any part of the body, it can cause severe internal burns in just 2 hours and can lead to death.
 - Keep new and used batteries away from children. If the smart key does not close securely, stop using the smart key and keep it away from children.
 - If you think a battery might have been swallowed or placed inside any part of the body, seek immediate medical attention.
- stop using the smart key, remove the battery, and keep them away from children.
 - Do not force discharge, recharge, disassemble, heat the battery to 100 °C (212 °F) or higher, or incinerate it. Doing so may result in injury due to venting, leakage or explosion resulting in chemical burns.
 - Even used batteries may cause severe injury or death. Immediately recycle or dispose of any used batteries according to local regulations and keep away from children. Do NOT dispose of batteries in household trash or incinerate. If consumed, call a local poison control center for treatment information.

EWA23170

WARNING

- The specified battery is not rechargeable, do not recharge the battery.
- Remove and immediately recycle or dispose of the smart key battery according to local regulations if the smart key will not be used for an extended period of time.
- Always make sure the smart key case is completely closed. If the case does not close securely,

Instrument and control functions

EUA8783

Main switch (T115FL-5CF)

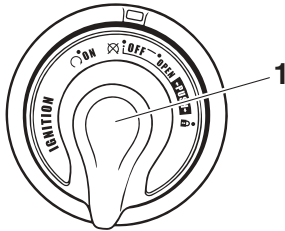

1. Main switch knob

The main switch is used to turn the vehicle power on/off, lock/unlock the steering and open the seat/fuel tank lid. To use the main switch:

1. Push the main switch knob inward. If the smart key is detected within range, the system will activate the main switch for approximately 4 seconds, and the smart key indicator light will come on. (See page 5-6.)
2. While holding the main switch knob in, turn it to the desired position within the 4-second window, before the smart key indicator light goes off.

EWA18720



WARNING
Never turn the main switch to “OFF”, “”, or “OPEN” while the vehicle is moving. Otherwise the electrical systems will be switched off, which may result in loss of control or an accident.

TIP

Do not repeatedly push or turn the main switch knob beyond normal use. Doing so will temporarily disable the smart key system to protect the main switch. When disabled, the smart key system indicator light will blink. If this occurs, wait until the smart key system indicator light stops blinking before operating the main switch again.

The main switch positions are described as follows:

EUA8661

ON

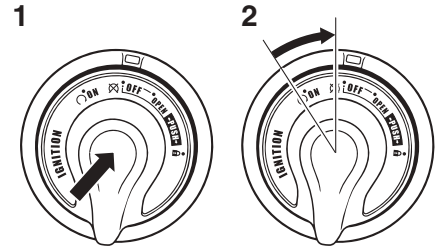

1. Push.
2. Turn.

All electrical circuits are supplied with power, and the engine can be started. When the main switch knob is turned to “ON”, all of the turn signal lights will flash twice and the vehicle power will turn on.

TIP

- If the vehicle battery voltage is low, the turn signal lights will not flash.
- See “Emergency mode” on page 8-31 for information on turning the vehicle power on without the smart key.

EAUJ2560

OPEN

The seat can be opened.

1. With the smart key on and within operating range, push the main switch knob.
2. While the smart key system indicator light is on, turn the main switch to “OPEN” and then lift the rear of the seat.

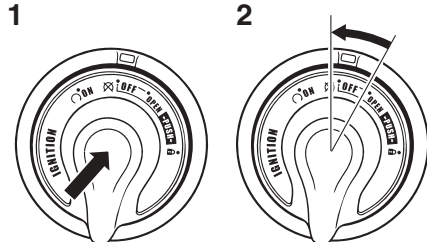

1. Push.
2. Turn.

TIP

Make sure that the seat is securely closed before starting off.

Open position reminder

To prevent you from accidentally leaving the vehicle unlocked by walking away with the main switch still in the

“OPEN” position, the smart key system beeper will sound under the following conditions.

- When the main switch has been in the “OPEN” position for 3 minutes
- If the smart key is turned off while the main switch is in the “OPEN” position
- If you walk out of range of the smart key system with the main switch in the “OPEN” position

If the beeper sounds after 3 minutes, turn the main switch to “OFF” or “”. If the beeper sounds because the smart key was turned off or moved out of range, turn the smart key on and walk back into range.

TIP

The beeper will turn off after 1 minute.

EAUJ8670

OFF

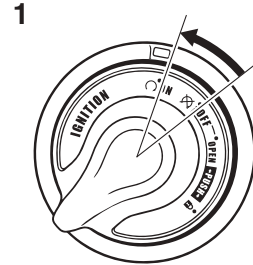

1. Turn.

All electrical systems are off.

When the main switch is turned to “OFF”, all the turn signal lights will flash once and the vehicle power turns off.

TIP

When the main switch is turned to “OFF” but the smart key cannot be confirmed (the smart key is either outside operation range or has been turned off), the beeper will sound for 3 seconds and the smart key system indicator light will flash for 30 seconds.

- For 30 seconds, the main switch can be freely operated.
- After 30 seconds, the vehicle power will turn off automatically.

Instrument and control functions

- To turn the vehicle power off immediately, push the main switch knob inward four times within 2 seconds.

3. While the smart key system indicator light is on, push and turn the main switch knob to “”.

2. While the smart key system indicator light is on, push and turn the main switch knob to the desired position.

TIP

If the steering will not lock, try turning the handlebar back to the right slightly.

EWA14742

WARNING

Do not operate the steering lock while the vehicle is moving.

To unlock the steering

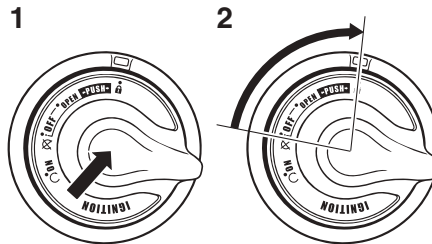

1. Push.
2. Turn.

1. With the smart key turned on and within operating range, push the main switch knob.

(Lock)

EUA8771

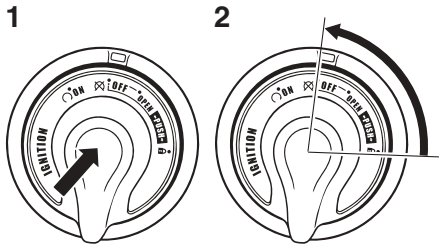

1. Push.
2. Turn.

The steering is locked and all electrical systems are off.

To lock the steering

1. Turn the handlebar all the way to the left.
2. With the smart key turned on and within operating range, push the main switch knob.

Main switch/steering lock (T115FL-2C / T115FL-5C)

EAU0353

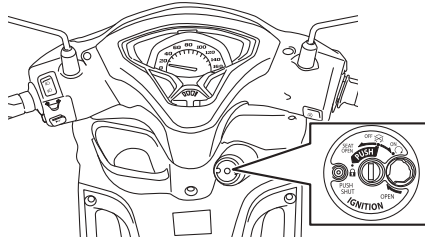

The main switch/steering lock controls the ignition and lighting systems, and is used to lock the steering, and is used to open the seat also. The various main switch positions are described below.

TIP

The main switch is equipped with a keyhole cover. (See page 5-5 for keyhole cover opening and closing procedures.)

ON

The ignition system is supplied with power, and the engine can be started. The key cannot be removed.

EAU85000

TIP

- To prevent battery discharge, do not leave the key in the on position without the engine running.
- The vehicle lights come on automatically when the engine is started.

EAU10664

OFF

All electrical systems are off. The key can be removed.

EWA10062

! WARNING

Never turn the key to “OFF” or “LOCK” while the vehicle is moving. Otherwise the electrical systems will be switched off, which may result in loss of control or an accident.

EAU1043

LOCK

The steering is locked, and all electrical systems are off. The key can be removed.

To lock the steering

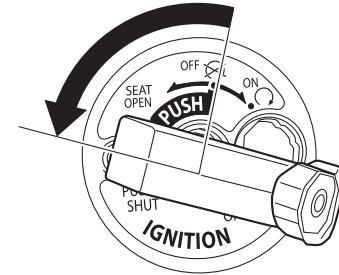

1. Turn the handlebars all the way to the left.
2. Push the key in from the “OFF” position, and then turn it to “LOCK” while still pushing it.
3. Remove the key.

TIP

If the steering will not lock, try turning the handlebars back to the right slightly.

Instrument and control functions

To unlock the steering

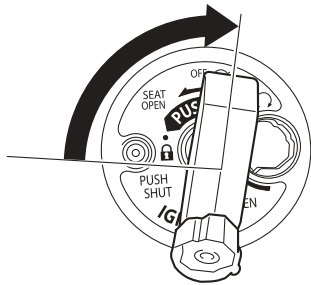

Push the key in, and then turn it to “OFF” while still pushing it.

EWAU0042

! WARNING

- Never turn the key to “OFF” or “LOCK” while the vehicle is moving; otherwise, the electrical systems will be switched off, which may result in loss of control or an accident.
- If the vehicle turns over, and after placing it upright, ensure that there is no fuel leakage. If fuel is leaking, have a Yamaha dealer check the vehicle.

Keyhole cover

EAUU0822

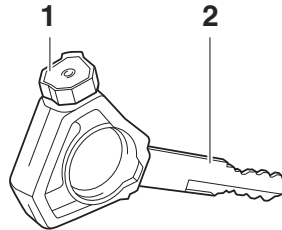

ZAUUV0280

1. Shutter key
2. Ignition key

To open the keyhole cover

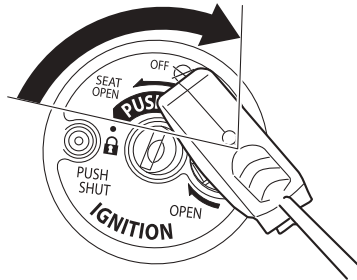

Insert the key head into the keyhole cover receptacle as shown, and then turn the key to the right to open the cover.

To close the keyhole cover

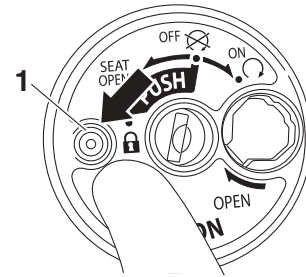

1. “PUSH SHUT” button

Press the “PUSH SHUT” button to close the keyhole cover.

Indicator lights and warning lights

EAU7712D

ECA29090

NOTICE

If an indicator or warning is signaling a problem or abnormal condition, then stop all vehicle operation immediately. Have a Yamaha dealer inspect the vehicle.

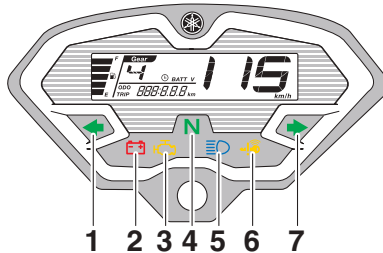

1. Left turn signal indicator light “←”
2. Battery voltage warning light “🔋” (T115FL-2C / T115FL-5C)
3. Engine trouble warning light “🔧”
4. Neutral indicator light “N”
5. High beam indicator light “☰D”
6. Smart key system indicator light “🔑” (T115FL-5CF)
7. Right turn signal indicator light “→”

Turn signal indicator lights “←” and “→”

EAU88680

Each indicator light will flash when its corresponding turn signal lights are flashing.

Neutral indicator light “N”

EAU91820

This indicator light comes on when the transmission is in the neutral position.

High beam indicator light “☰D”

EAU88910

This indicator light comes on when the high beam of the headlight is switched on.

Engine trouble warning light “🔧”

EAU89430

This warning light comes on if a problem is detected in the engine or other vehicle control system. If this occurs, have a Yamaha dealer check the on-board diagnostic system.

TIP

When the vehicle is turned on, this light should come on for a few seconds and then go off. Otherwise, have a Yamaha dealer check vehicle.

Battery voltage warning light “🔋” (T115FL-2C / T115FL-5C)

EAUJ2570

This warning light comes on when the battery voltage gets low. If this occurs, have a Yamaha dealer check the battery for charging.

Smart key system indicator light “🔑” (T115FL-5CF)

EAUN2772

This indicator light communicates the status of the smart key system. When the smart key system is operating normally, this indicator light will be off. If there is an error in the smart key system, the indicator light will flash. The indicator light will also flash when communication between the vehicle and smart key takes place and when certain smart key system operations are carried out.

Instrument and control functions

Multi-function meter unit

EAUN4051

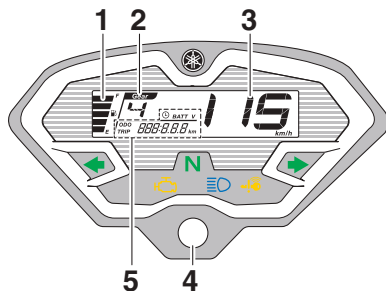

1. Fuel meter
2. Transmission gear display
3. Speedometer
4. "RESET/SELECT" button
5. Multi-function display

WARNING

EWA12423

Be sure to stop the vehicle before making any setting changes to the multi-function meter unit. Changing settings while riding can distract the operator and increase the risk of an accident.

TIP

Be sure to turn the main switch on before using the "RESET/SELECT" button.

Speedometer

EAU86831

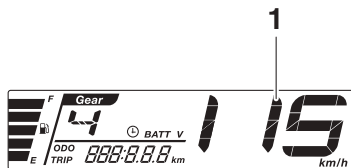

1. Speedometer

The speedometer shows the vehicle's traveling speed.

Fuel meter

EAUN3851

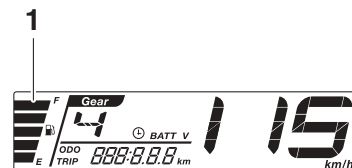

1. Fuel meter

The fuel meter indicates the amount of fuel in the fuel tank. The display segments of the fuel meter disappear from "F" (full) towards "E" (empty) as the fuel level decreases. When the last segment starts flashing, refuel as soon as possible.

TIP

If a problem is detected in the electrical circuit, the fuel level segments will flash repeatedly. If this occurs, have a Yamaha dealer check the vehicle.

NOTICE

Do not let the vehicle run completely out of fuel. This may cause damage to the catalytic converter.

ECAE0121

Transmission gear display

EAU87391

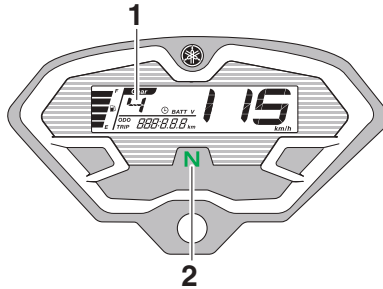

1. Transmission gear display
2. Neutral indicator light "N"

This display shows the selected gear. The neutral position is indicated by "-" and by the neutral indicator light.

Multi-function display

EAU4061



1

1. Multi-function display

The multi-function display contains the following functions:

- odometer (ODO)
- tripmeter (TRIP)
- clock
- battery voltage display (BATT)

Use the "RESET/SELECT" button to cycle the multi-function display between the functions in the following order:

ODO → TRIP → BATT → CLOCK → ODO

Odometer

EAU86891



1

1. Odometer

The odometer shows the total distance traveled by the vehicle.

TIP

The odometer will lock at "999999" and cannot be reset.

Instrument and control functions

Tripmeter

EAU88030



1

1. Tripmeter

The tripmeter shows the distance traveled since it was last reset.

To reset the tripmeter, change the display to the tripmeter, and then push the “RESET/SELECT” button until it is reset.

TIP

The tripmeter will reset and continue counting after 9999.9 is reached.

Clock

EAUN4071



1

1. Clock

The clock uses a 12-hour time system.

To set the clock

1. Use the “RESET/SELECT” button to change the display to the clock.
2. Hold the “RESET/SELECT” button until the hour digits start flashing.
3. Use the “RESET/SELECT” button to set the hours.
4. Hold the “RESET/SELECT” button until the minute digits start flashing.
5. Use the “RESET/SELECT” button to set the minutes.
6. Hold the “RESET/SELECT” button to confirm the settings.

TIP

When the CCU and a smartphone are connected, the clock is automatically updated.

Battery voltage display

EAU86960

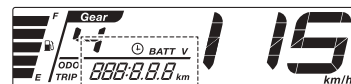

1

1. Battery voltage display

This display shows the current charge state of the battery.

- Over 12.8 V = Full charge.
- Under 12.7 V = Charging is required.

TIP

If the battery voltage is less than 9.0 V, “_ _ . _” is displayed.

5

Handlebar switches

Left

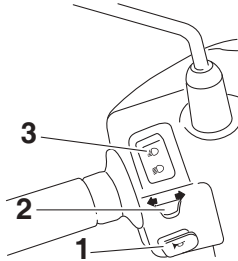

1. Horn switch “

Right

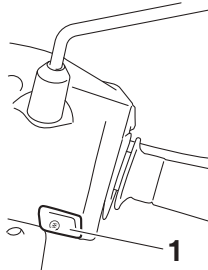

1. Start switch

EAU1234U

Dimmer switch “ EAU12402

Set this switch to “

Turn signal switch “ EAU12461

To signal a right-hand turn, push this switch to “

Horn switch “ EAU12501

Press this switch to sound the horn.

Start switch “ EAU12713

Push this switch to crank the engine with the starter. See page 7-2 for starting instructions prior to starting the engine.

Shift pedal

EAU37462

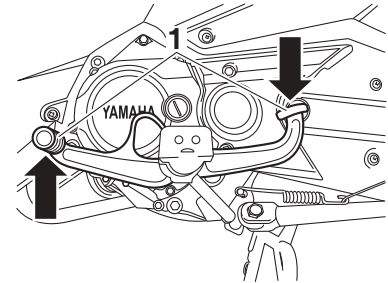

1. Shift pedal

The shift pedal is located on the left side of the motorcycle. This motorcycle is equipped with a constant-mesh 4 speed transmission.

TIP

Use your toes to shift up and your heel to shift down.

Instrument and control functions

Brake lever

EAU12892

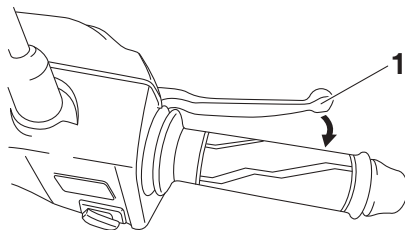

1. Brake lever

The brake lever is located on the right side of the handlebar. To apply the front brake, pull the lever toward the throttle grip.

Brake pedal

EAUW3770

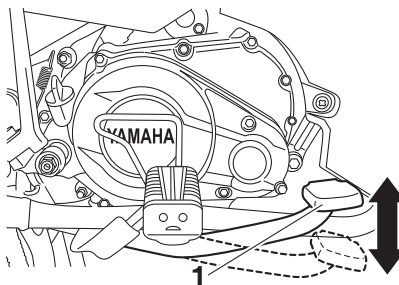

1. Brake pedal

The brake pedal is located on the right side of the vehicle.

To apply the rear brake, press down on the brake pedal.

This model is equipped with a unified brake system.

When pressing down on the brake pedal, the rear brake and a portion of the front brake are applied. For full braking performance, apply both the brake lever and the brake pedal simultaneously.

TIP

- As the unified brake system is mechanical, additional free play can be felt in the front brake lever when the rear brake pedal is being pressed down.
- The unified brake system does not function when the front brake is applied alone.

Fuel tank cap

EAU37474

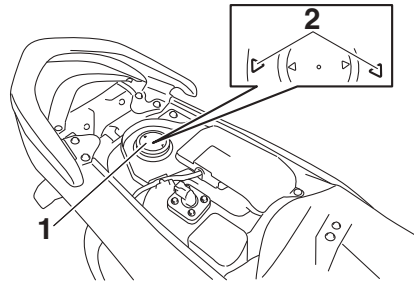

1. Fuel tank cap
2. “△” mark

To remove the fuel tank cap

1. Open the seat. (See page 5-14.)
2. Turn the fuel tank cap counter-clockwise and pull it off.

To install the fuel tank cap

1. Insert the fuel tank cap into the tank opening and turn it clockwise until the “△” marks on the cap and tank cover are aligned.
2. Close the seat.

! WARNING

Make sure that the fuel tank cap is properly closed after filling fuel. Leaking fuel is a fire hazard.

EWA11092

Fuel

Make sure there is sufficient gasoline in the tank.

EAU13213

! WARNING

Gasoline and gasoline vapors are extremely flammable. To avoid fires and explosions and to reduce the risk of injury when refueling, follow these instructions.

EWA10882

1. Before refueling, turn off the engine and be sure that no one is sitting on the vehicle. Never refuel while smoking, or while in the vicinity of sparks, open flames, or other sources of ignition such as the pilot lights of water heaters and clothes dryers.
2. Do not overfill the fuel tank. Stop filling when the fuel reaches the bottom of the filler tube. Because fuel expands when it heats up, heat from the engine or the sun can cause fuel to spill out of the fuel tank.

Instrument and control functions

5

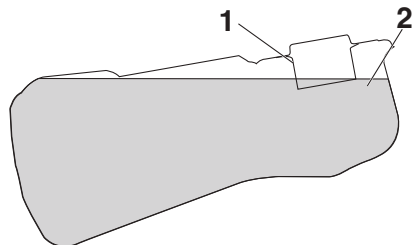

1. Fuel tank filler tube
2. Maximum fuel level
3. Wipe up any spilled fuel immediately. **NOTICE:** Immediately wipe off spilled fuel with a clean, dry, soft cloth, since fuel may deteriorate painted surfaces or plastic parts. [ECA10072]
4. Be sure to securely close the fuel tank cap.

EWA15152

WARNING

Gasoline is poisonous and can cause injury or death. Handle gasoline with care. Never siphon gasoline by mouth. If you should swallow some gasoline or inhale a lot of gasoline vapor, or get some gasoline in your eyes, see your doctor immedi-

ately. If gasoline spills on your skin, wash with soap and water. If gasoline spills on your clothing, change your clothes.

EAUN0750

Recommended fuel:

Regular unleaded gasoline (E10 to E20 only)

Fuel tank capacity:

4.0 L (1.1 US gal, 0.9 Imp.gal)

ECA11401

NOTICE

Use only unleaded gasoline. The use of leaded gasoline will cause severe damage to internal engine parts, such as the valves and piston rings, as well as to the exhaust system.

EAU13435

Catalytic converter

The exhaust system contains catalytic converter(s) to reduce harmful exhaust emissions.

EWA10863

WARNING

The exhaust system is hot after operation. To prevent a fire hazard or burns:

- Do not park the vehicle near possible fire hazards such as grass or other materials that easily burn.
- Park the vehicle in a place where pedestrians or children are not likely to touch the hot exhaust system.
- Make sure that the exhaust system has cooled down before doing any maintenance work.
- Do not allow the engine to idle more than a few minutes. Long idling can cause a build-up of heat.

Kickstarter (T115FL-2C / T115FL-5C)

EAU37652

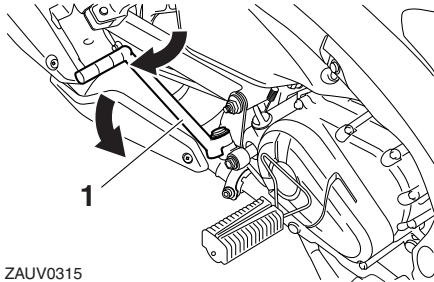

ZAUV0315

1. Kickstarter

If the engine fails to start by pushing the start switch, try to start it by using the kickstarter. To start the engine, fold out the kickstarter lever, move it down lightly with your foot until the gears engage, and then push it down smoothly but forcefully.

Seat (T115FL-2C/T115FL-5C)

EAU0373

To open the seat

1. Place the vehicle on the center-stand.
2. Insert the key into the main switch, and then turn it counterclockwise to "OPEN".

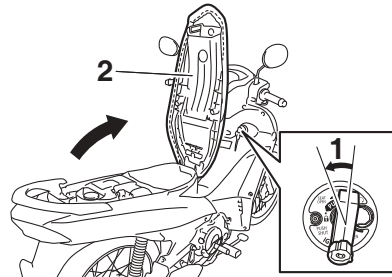

1. Seat lock
2. Seat

TIP

Do not push inward when turning the key.

3. Fold the seat up.

To close the seat

1. Fold the seat down, and then push it down to lock it in place.
2. Remove the key from the main switch if the vehicle will be left unattended.

TIP

Make sure that the seat is properly secured before riding.

Instrument and control functions

Helmet holders

EAU37482

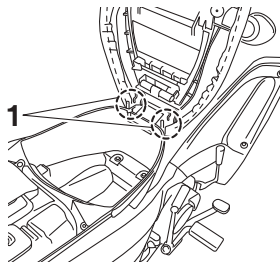

1. Helmet holder

The helmet holders are located under the seat.

To secure a helmet to a helmet holder

1. Open the seat. (See page 5-14.)
2. Attach a helmet to a helmet holder, and then securely close the seat. **WARNING! Never ride with a helmet attached to the helmet holder, since the helmet may hit objects, causing loss of control and possibly an accident.** [EWA10162]

To release a helmet from a helmet holder

Open the seat, remove the helmet from the helmet holder, and then close the seat.

Storage compartments

EAU57081

Front storage compartment

The front storage compartment is located at the front of the vehicle. Use this compartment for small items.

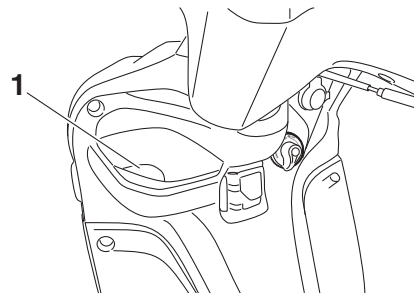

1. Front storage compartment

WARNING

- Do not exceed the load limit of 1 kg (2.2 lb) for the front storage compartment.
- Do not place anything in the front storage compartment that will interfere with your operating the vehicle.

EWA17250

ECA21150

Rear storage compartment

The rear storage compartment is located under the seat. Use this compartment for large items. (See page 5-14.)

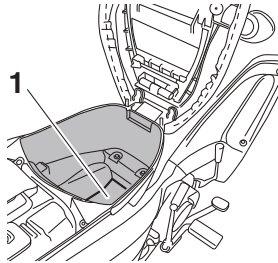

1. Rear storage compartment

EWAT1052

WARNING

- Do not exceed the load limit of 3 kg (6.6 lb) for the rear storage compartment.
- Do not exceed the maximum load of 154 kg (340 lb) (T115FL-2C, T115FL-5CF) 155 kg (342 lb) (T115FL-5C) for the vehicle.

NOTICE

Keep the following points in mind when using the storage compartment.

- Since the storage compartment accumulates heat when exposed to the sun and/or the engine heat, do not store anything susceptible to heat, consumables or flammable items inside it.
- To avoid humidity from spreading through the storage compartment, wrap wet articles in a plastic bag before storing them in the compartment.
- Since the storage compartment may get wet while the vehicle is being washed, wrap any articles stored in the compartment in a plastic bag.
- Do not keep anything valuable or breakable in the storage compartment.

TIP

Do not leave your vehicle unattended with the seat open.

Instrument and control functions

Luggage hook

EAU61380

To use the luggage hook, pull it out as shown.

To retract the luggage hook, push it back to its original position.

EWAT1032

WARNING

- Do not exceed the load limit of 1 kg (2.2 lb) for the luggage hook.
- Do not exceed the maximum load of 154 kg (340 lb) (T115FL-2C, T115FL-5CF) 155 kg (342 lb) (T115FL-5C) for the vehicle.

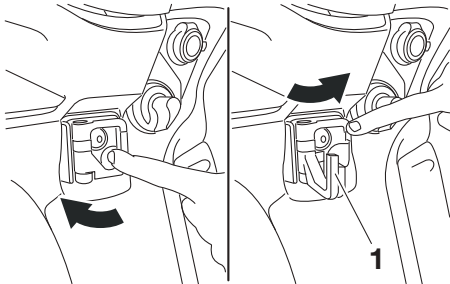

1. Luggage hook

Power outlet

EAUN2163

This model is equipped with a 12V DC power outlet.

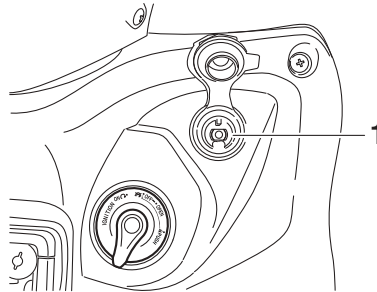

1. Power outlet

NOTICE

ECAN0140

Do not use the power outlet when the engine is off, and do not exceed the specified electrical load; otherwise the fuse may blow or the battery may discharge.

When washing the vehicle, do not direct high-pressure washers at the power outlet area.

**Maximum electrical load:
12W (1A)**

To use the power outlet

1. Turn the vehicle power off.
2. Remove the power outlet cap.

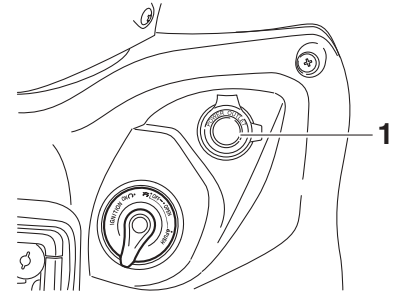

1. Power outlet cap

3. Turn the accessory off.
4. Insert the accessory plug into the power outlet.
5. Turn the vehicle power on and start the engine.
6. Turn the accessory on.

TIP

When finished riding, turn off the accessory and disconnect it from the power outlet, and then install the cap.

 **WARNING**

EWAN0050

To prevent electrical shock or short-circuiting, install the cap when the power outlet is not in use.

EAU37491

Sidestand

The sidestand is located on the left side of the frame. Raise the sidestand or lower it with your foot while holding the vehicle upright.

EWA14191

 **WARNING**

The vehicle must not be ridden with the sidestand down, or if the sidestand cannot be properly moved up (or does not stay up), otherwise the sidestand could contact the ground and distract the operator, resulting in a possible loss of control.

For your safety – pre-operation checks

EAU1559B

Inspect your vehicle each time you use it to make sure the vehicle is in safe operating condition. Always follow the inspection and maintenance procedures and schedules described in the Owner's Manual.

EWA11152

WARNING

Failure to inspect or maintain the vehicle properly increases the possibility of an accident or equipment damage. Do not operate the vehicle if you find any problem. If a problem cannot be corrected by the procedures provided in this manual, have the vehicle inspected by a Yamaha dealer.

Before using this vehicle, check the following points:

ITEM	CHECKS	PAGE
Fuel	<ul style="list-style-type: none">• Check fuel level in fuel tank.• Refuel if necessary.• Check fuel line for leakage.	5-12
Engine oil	<ul style="list-style-type: none">• Check oil level in engine.• If necessary, add recommended oil to specified level.• Check vehicle for oil leakage.	8-9
Front brake	<ul style="list-style-type: none">• Check operation.• If soft or spongy, have Yamaha dealer bleed hydraulic system.• Check brake pads for wear.• Replace if necessary.• Check fluid level in reservoir.• If necessary, add specified brake fluid to specified level.• Check hydraulic system for leakage.	8-18, 8-19
Rear brake	<ul style="list-style-type: none">• Check operation.• Check pedal free play.• Adjust if necessary.	8-17, 8-18
Throttle grip	<ul style="list-style-type: none">• Make sure that operation is smooth.• Check throttle grip free play.• If necessary, have Yamaha dealer adjust throttle grip free play and lubricate cable and grip housing.	8-13, 8-22

For your safety – pre-operation checks

ITEM	CHECKS	PAGE
Control cables	<ul style="list-style-type: none"> • Make sure that operation is smooth. • Lubricate if necessary. 	8-22
Drive chain	<ul style="list-style-type: none"> • Check chain slack. • Adjust if necessary. • Check chain condition. • Lubricate if necessary. 	8-20, 8-21
Wheels and tires	<ul style="list-style-type: none"> • Check for damage. • Check tire condition and tread depth. • Check air pressure. • Correct if necessary. 	8-14, 8-16
Brake pedal	<ul style="list-style-type: none"> • Make sure that operation is smooth. • Lubricate pedal pivoting point if necessary. 	8-23
Brake lever	<ul style="list-style-type: none"> • Make sure that operation is smooth. • Lubricate lever pivoting point if necessary. 	8-22
Centerstand, sidestand	<ul style="list-style-type: none"> • Make sure that operation is smooth. • Lubricate pivots if necessary. 	8-23
Chassis fasteners	<ul style="list-style-type: none"> • Make sure that all nuts, bolts and screws are properly tightened. • Tighten if necessary. 	—
Instruments, lights, signals and switches	<ul style="list-style-type: none"> • Check operation. • Correct if necessary. 	—

Operation and important riding points

EAU15952

Read the Owner's Manual carefully to become familiar with all controls. If there is a control or function you do not understand, ask your Yamaha dealer.

EWA10272

WARNING

Failure to familiarize yourself with the controls can lead to loss of control, which could cause an accident or injury.

7

Engine break-in

There is never a more important period in the life of your engine than the period between 0 and 1000 km (600 mi). For this reason, you should read the following material carefully.

Since the engine is brand new, do not put an excessive load on it for the first 1000 km (600 mi). The various parts in the engine wear and polish themselves to the correct operating clearances. During this period, prolonged full-throttle operation or any condition that might result in engine overheating must be avoided.

EAU16831

150–500 km (90–300 mi)

Avoid prolonged operation above 1/2 throttle.

Rev the engine freely through the gears, but do not use full throttle at any time.

500–1000 km (300–600 mi)

Avoid prolonged operation above 3/4 throttle.

1000 km (600 mi) and beyond

Avoid prolonged full-throttle operation. Vary the engine speed occasionally.

NOTICE: After 1000 km (600 mi) of operation, the engine oil must be changed, the oil filter cartridge or element replaced, and the oil strainer cleaned. If any engine trouble should occur during the engine break-in period, immediately have a Yamaha dealer check the vehicle.

[ECA10363]

EAU37793

0–150 km (0–90 mi)

Avoid prolonged operation above 1/3 throttle.

After every hour of operation, stop the engine, and then let it cool for five to ten minutes.

Vary the engine speed from time to time. Do not operate the engine at one set throttle position.

Operation and important riding points

Starting and warming up a cold engine

EAUJ0443

To start the engine

1. Place the vehicle on the centerstand.
2. Turn the main switch on.
3. Confirm the indicator and warning light(s) come on for a few seconds, and then go off. (See page 5-6.)

TIP

Do not start the engine if the engine trouble warning light remains on.

ECA26710

NOTICE

Do not continue to operate the vehicle if a warning light remains on. Have a Yamaha dealer check the vehicle.

4. Shift the transmission into the neutral position.

WARNING

Before starting the engine, make sure the transmission is in neutral and that the vehicle is placed on the centerstand.

5. While applying the front or rear brake, push the start switch.
6. Release the start switch when the engine starts, or after 5 seconds. Wait 10 seconds before pressing the switch again to allow battery voltage to restore.

TIP

- If the engine fails to start, try again with the throttle grip open 1/4 turn (10 mm).
- If the engine does not start with the starter motor, try using the kickstarter.

EWA14201

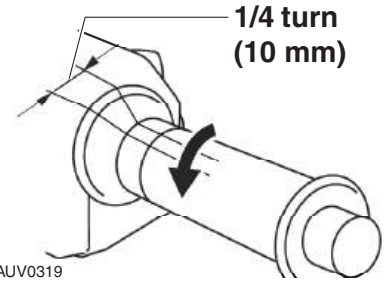

ZAUJ0319

ECA11043

NOTICE

For maximum engine life, never accelerate hard when the engine is cold!

Operation and important riding points

EAU58351

EAU37552

ECA15182

ECAN0072

NOTICE

Do not ride through deep water, otherwise the engine may be damaged. Avoid puddles because they may be deeper than expected.

TIP

The engine cannot be started if the battery voltage is less than 11.50 volts or the battery is not installed.

Shifting

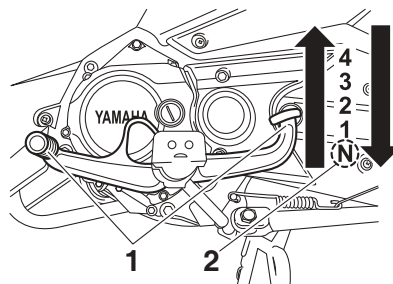

1. Shift pedal
2. Neutral position

Shifting gears lets you control the amount of engine power available for starting off, accelerating, climbing hills, etc. When shifting gears, fully return the throttle grip. The use of the shift pedal is shown in the illustration.

TIP

The transmission cannot be shifted from 4th gear to neutral when the engine is running.

NOTICE

- When shifting, press the shift pedal firmly until you feel the gear shift is complete.
- Even with the transmission in the neutral position, do not coast for long periods of time with the engine off, nor tow the motorcycle for long distances. The transmission is properly lubricated only when the engine is running. Inadequate lubrication may damage the transmission.
- Be sure to fully close the throttle grip when shifting.

EAU16811

Tips for reducing fuel consumption

Fuel consumption depends largely on your riding style. Consider the following tips to reduce fuel consumption:

- Shift up swiftly, and avoid high engine speeds during acceleration.
- Do not rev the engine while shifting down, and avoid high engine speeds with no load on the engine.
- Turn the engine off instead of letting it idle for an extended length of time (e.g., in traffic jams, at traffic lights or at railroad crossings).

EAU17214

Parking

When parking, stop the engine, and then remove the key from the main switch.

EWA10312

WARNING

- **Since the engine and exhaust system can become very hot, park in a place where pedestrians or children are not likely to touch them and be burned.**
 - **Do not park on a slope or on soft ground, otherwise the vehicle may overturn, increasing the risk of a fuel leak and fire.**
 - **Do not park near grass or other flammable materials which might catch fire.**
-

Periodic maintenance and adjustment

EAU17246

Periodic inspection, adjustment, and lubrication will keep your vehicle in the safest and most efficient condition possible. Safety is an obligation of the vehicle owner/operator. The most important points of vehicle inspection, adjustment, and lubrication are explained on the following pages.

The intervals given in the periodic maintenance charts should be simply considered as a general guide under normal riding conditions. However, depending on the weather, terrain, geographical location, and individual use, the maintenance intervals may need to be shortened.

EWA10322

WARNING

Failure to properly maintain the vehicle or performing maintenance activities incorrectly may increase your risk of injury or death during service or while using the vehicle. If you are not familiar with vehicle service, have a Yamaha dealer perform service.

EWA15123

WARNING

Turn off the engine when performing maintenance unless otherwise specified.

- **A running engine has moving parts that can catch on body parts or clothing and electrical parts that can cause shocks or fires.**
- **Running the engine while servicing can lead to eye injury, burns, fire, or carbon monoxide poisoning – possibly leading to death. See page 2-2 for more information about carbon monoxide.**

EWA15461

WARNING

Brake discs, calipers, drums, and linings can become very hot during use. To avoid possible burns, let brake components cool before touching them.

EAU85230

Tool kit

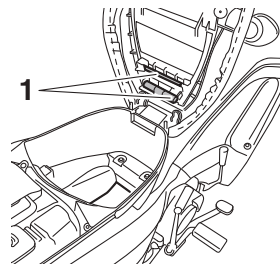

1. Tool kit

The tool kit is in the location shown. The information included in this manual and the tools provided in the tool kit are intended to assist you in the performance of preventive maintenance and minor repairs. However, a torque wrench and other tools are necessary to perform certain maintenance work correctly.

TIP

If you do not have the tools or experience required for a particular job, have your Yamaha dealer perform it for you.

Periodic maintenance and adjustment

EAUU0621

TIP

- The annual checks must be performed every year, except if a kilometer-based maintenance is performed instead.
- From 20000 km, repeat the maintenance intervals starting from 4000 km.
- Items marked with an asterisk should be performed by a Yamaha dealer as they require special tools, data and technical skills.

Periodic maintenance chart for the emission control system

EAUU2431

NO.	ITEM	CHECK OR MAINTENANCE JOB	ODOMETER READING (whichever comes first)					ANNUAL CHECK
			1000 km or 1 month	4000 km or 4 months	8000 km or 8 months	12000 km or 12 months	16000 km or 16 months	
1	* Fuel line	<ul style="list-style-type: none"> • Check fuel hoses for cracks or damage. 		√	√	√	√	√
2	* Fuel filter	<ul style="list-style-type: none"> • Check condition. • Replace if necessary. 	Every 12000 km (7500 mi)					
3	Spark plug	<ul style="list-style-type: none"> • Check condition. • Clean and regap. 		√	√	√	√	
		<ul style="list-style-type: none"> • Replace. 	Every 8000 km (5000 mi)					
4	* Valves	<ul style="list-style-type: none"> • Check valve clearance. • Adjust if necessary. 			√		√	
5	* Fuel injection	<ul style="list-style-type: none"> • Check engine idle speed. 	√	√	√	√	√	√
6	* Exhaust system	<ul style="list-style-type: none"> • Check for leakage. • Tighten if necessary. • Replace gasket(s) if necessary. 		√	√	√	√	√

Periodic maintenance and adjustment

EAUU2441

General maintenance and lubrication chart

NO.	ITEM	CHECK OR MAINTENANCE JOB	ODOMETER READING (whichever comes first)					ANNUAL CHECK
			1000 km or 1 month	4000 km or 4 months	8000 km or 8 months	12000 km or 12 months	16000 km or 16 months	
1	* Diagnostic system check	<ul style="list-style-type: none"> Perform dynamic inspection using Yamaha diagnostic tool. Check the error codes. 	√	√	√	√	√	√
2	Air filter element	<ul style="list-style-type: none"> Replace. 	Every 16000 km (10000 mi)					
3	Air filter check hose	<ul style="list-style-type: none"> Clean. 	√	√	√	√	√	
4	* Battery	<ul style="list-style-type: none"> Check voltage. Charge if necessary. 	√	√	√	√	√	√
5	* Front brake (disc brake)	<ul style="list-style-type: none"> Check operation, fluid level and vehicle for fluid leakage. 	√	√	√	√	√	√
		<ul style="list-style-type: none"> Replace brake pads. 	Whenever worn to the limit					
5	* Front brake (drum brake)	<ul style="list-style-type: none"> Check operation and adjust brake lever free play. 	√	√	√	√	√	√
		<ul style="list-style-type: none"> Replace brake shoes. 	Whenever worn to the limit					
6	* Rear brake	<ul style="list-style-type: none"> Check operation and adjust brake pedal free play. 	√	√	√	√	√	√
		<ul style="list-style-type: none"> Replace brake shoes. 	Whenever worn to the limit					
7	* Brake hose (disc brake)	<ul style="list-style-type: none"> Check for cracks or damage. Check for correct routing and clamping. 		√	√	√	√	√
		<ul style="list-style-type: none"> Replace. 	Every 4 years					
8	* Brake fluid (disc brake)	<ul style="list-style-type: none"> Change. 	Every 2 years					

Periodic maintenance and adjustment

NO.	ITEM	CHECK OR MAINTENANCE JOB	ODOMETER READING (whichever comes first)					ANNUAL CHECK
			1000 km or 1 month	4000 km or 4 months	8000 km or 8 months	12000 km or 12 months	16000 km or 16 months	
9	* Wheels (cast)	<ul style="list-style-type: none"> • Check runout and for damage. 		√	√	√	√	
	* Wheels (spoke)	<ul style="list-style-type: none"> • Check runout, spoke tightness and for damage. • Tighten spokes if necessary. 	√	√	√	√	√	
10	* Tires	<ul style="list-style-type: none"> • Check tread depth and for damage. • Replace if necessary. • Check air pressure. • Correct if necessary. 		√	√	√	√	√
11	* Wheel bearings	<ul style="list-style-type: none"> • Check bearings for looseness or damage. 		√	√	√	√	
12	* Swingarm	<ul style="list-style-type: none"> • Check operation and for excessive play. 		√	√	√	√	
		<ul style="list-style-type: none"> • Lubricate with lithium-soap-based grease. 	Every 12000 km (7500 mi)					
13	Drive chain	<ul style="list-style-type: none"> • Check chain slack, alignment and condition. • Adjust and thoroughly lubricate chain with engine oil. 	Every 1000 km and after washing the motorcycle or riding in the rain					
14	* Steering bearings	<ul style="list-style-type: none"> • Check bearing play and steering for roughness. 	√	√	√	√	√	
		<ul style="list-style-type: none"> • Lubricate with lithium-soap-based grease. 	Every 12000 km (7500 mi)					
15	* Chassis fasteners	<ul style="list-style-type: none"> • Make sure that all nuts, bolts and screws are properly tightened. 		√	√	√	√	√
16	Brake lever pivot shaft	<ul style="list-style-type: none"> • Lubricate with silicone grease. 		√	√	√	√	√

Periodic maintenance and adjustment

NO.	ITEM	CHECK OR MAINTENANCE JOB	ODOMETER READING (whichever comes first)					ANNUAL CHECK
			1000 km or 1 month	4000 km or 4 months	8000 km or 8 months	12000 km or 12 months	16000 km or 16 months	
17 *	Unified brake system	• Check cable free play and adjust if necessary.	√	√	√	√	√	√
		• Lubricate link pivot of brake pedal with lithium-soap-based grease.	√	√	√	√	√	√
18	Brake pedal pivot shaft	• Lubricate with lithium-soap-based grease.		√	√	√	√	√
19	Shift pedal pivot shaft	• Lubricate with lithium-soap-based grease.		√	√	√	√	√
20	Sidestand, centerstand	• Check operation. • Lubricate with lithium-soap-based grease.		√	√	√	√	√
21 *	Front fork	• Check operation and for oil leakage.		√	√	√	√	
22 *	Shock absorber assemblies	• Check operation and shock absorbers for oil leakage.		√	√	√	√	
23	Engine oil	• Change. • Check oil level and vehicle for oil leakage.	√	√	√	√	√	
24	Engine oil filter element	• Replace.	√		√		√	
25 *	Front and rear brake switches	• Check operation.	√	√	√	√	√	√
26	Moving parts and cables	• Lubricate.		√	√	√	√	√

Periodic maintenance and adjustment

NO.	ITEM	CHECK OR MAINTENANCE JOB	ODOMETER READING (whichever comes first)					ANNUAL CHECK
			1000 km or 1 month	4000 km or 4 months	8000 km or 8 months	12000 km or 12 months	16000 km or 16 months	
27	* Throttle grip	<ul style="list-style-type: none"> • Check operation. • Check throttle grip free play, and adjust if necessary. • Lubricate cable and grip housing. 		√	√	√	√	√
28	* Lights, signals and switches	<ul style="list-style-type: none"> • Check operation. • Adjust headlight beam. 	√	√	√	√	√	√

EAU18681

TIP

- Air filter
 - This model's air filter is equipped with a disposable oil-coated paper element, which must not be cleaned with compressed air to avoid damaging it.
 - The air filter element needs to be replaced more frequently when riding in unusually wet or dusty areas.
- Hydraulic brake service
 - Regularly check and, if necessary, correct the brake fluid level.
 - Every two years replace the internal components of the brake master cylinders and calipers, and change the brake fluid.
 - Replace the brake hoses every four years and if cracked or damaged.

Periodic maintenance and adjustment

Removing and installing the panel

EAU18752

The panel shown needs to be removed to perform some of the maintenance jobs described in this chapter. Refer to this section each time the panel needs to be removed and installed.

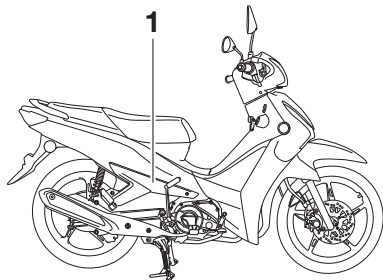

1. Panel A

EAU1610

Panel A

To remove the panel

Remove the bolts and screws, and then take the panel off.

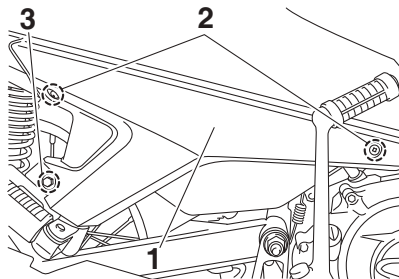

1. Panel A
2. Screw
3. Bolt

To install the panel

Place the panel in the original position, and then install the bolts and screws.

Checking the spark plug

EAU19608

The spark plug is an important engine component, which is easy to check. Since heat and deposits will cause any spark plug to slowly erode, the spark plug should be removed and checked in accordance with the periodic maintenance and lubrication chart. In addition, the condition of the spark plug can reveal the condition of the engine.

To remove the spark plug

1. Remove the spark plug cap.
2. Remove the spark plug as shown, with the spark plug wrench included in the tool kit.

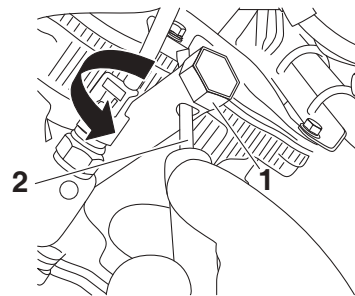

1. Spark plug wrench
2. Screwdriver

Periodic maintenance and adjustment

To check the spark plug

1. Check that the porcelain insulator around the center electrode of the spark plug is a medium-to-light tan (the ideal color when the vehicle is ridden normally).

TIP

If the spark plug shows a distinctly different color, the engine could be operating improperly. Do not attempt to diagnose such problems yourself. Instead, have a Yamaha dealer check the vehicle.

2. Check the spark plug for electrode erosion and excessive carbon or other deposits, and replace it if necessary.

Specified spark plug:

NGK/CR6HSA

3. Measure the spark plug gap with a wire thickness gauge and, if necessary, adjust the gap to specification.

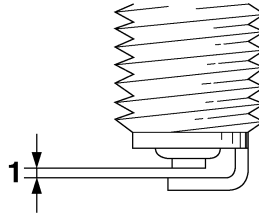

1. Spark plug gap

Spark plug gap:

0.6–0.7 mm (0.024–0.028 in)

To install the spark plug

1. Clean the surface of the spark plug gasket and its mating surface, and then wipe off any grime from the spark plug threads.
2. Install the spark plug with the spark plug wrench, and then tighten it to the specified torque.

Tightening torque:

Spark plug:

12.5 N·m (1.25 kgf·m, 9.2 lb·ft)

TIP

If a torque wrench is not available when installing a spark plug, a good estimate of the correct torque is 1/4–1/2 turn past finger tight. However, the spark plug should be tightened to the specified torque as soon as possible.

3. Install the spark plug cap.

Periodic maintenance and adjustment

Engine oil and oil filter element

EAUJ02060

The engine oil level should be checked regularly. In addition, the oil must be changed and the oil filter element replaced at the intervals specified in the periodic maintenance chart.

Recommended brand:

YAMALUBE

SAE viscosity grade:

10W-40

API service grade:

SG or higher, JASO standard MA

Oil quantity:

Oil change:

0.80 L (0.85 US qt, 0.70 Imp.qt)

With oil filter removal:

0.85 L (0.90 US qt, 0.75 Imp.qt)

ECAW0033

NOTICE

- In order to prevent clutch slippage (since the engine oil also lubricates the clutch), do not mix any chemical additives. Do not use oils with a diesel specification of "CD". Make sure that the engine oil doesn't contain friction-reducing additives.

- Make sure that no foreign material enters the crankcase.

To check the engine oil level

1. Start the engine, warm it up for several minutes, and then turn it off.
2. Wait a few minutes until the oil settles.
3. With the vehicle on a level surface, hold it in an upright position for an accurate reading.
4. Remove the oil filler cap and wipe the dipstick clean, then insert the dipstick back into the oil filler hole (without screwing it in), and then remove it again to check the oil level. **WARNING! Never remove the engine oil filler cap after high-speed operation, otherwise hot engine oil could spout out and cause damage or injury. Always let the engine oil cool down sufficiently before removing the oil filler cap.** [EWA17640]

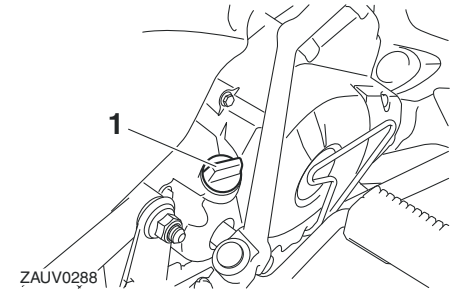

1. Engine oil filler cap

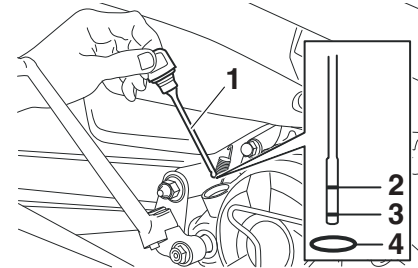

1. Dipstick
2. Maximum level mark
3. Minimum level mark
4. O-ring

5. If the engine oil is at or below the minimum level mark, add oil.
6. Check the oil O-ring for damage. Replace if necessary.

Periodic maintenance and adjustment

7. Install the oil filler cap.

To change the engine oil (and replace the filter)

1. Start the engine, warm it up for several minutes, and then turn it off.
2. Place an oil pan under the engine to collect the used oil.
3. Remove the engine oil filler cap.
4. Remove the engine oil drain bolt and gasket. Discard the used gasket.

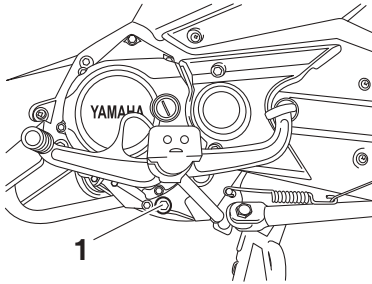

1. Engine oil drain bolt

TIP

Skip steps 4–6 if the oil filter element is not being replaced.

5. Remove the oil filter element cover by removing the bolts.

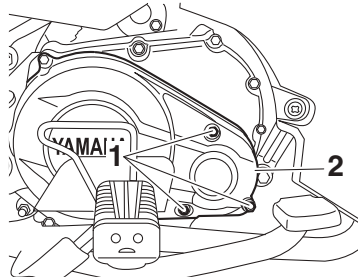

1. Bolt
2. Oil filter element cover

6. Remove the used oil filter element and O-rings. Replace with new parts.

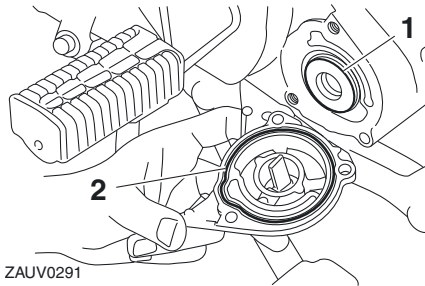

ZAUU0291

1. Oil filter element
2. O-ring

TIP

Make sure the O-rings are properly seated.

7. Install the oil filter element cover and tighten the bolts.

Tightening torque:

Oil filter element cover bolt:
10 N·m (1.0 kgf·m, 7.4 lb·ft)

8. Install the engine oil drain bolt with a new gasket and tighten the bolt.

Tightening torque:

Engine oil drain bolt:
20 N·m (2.0 kgf·m, 15 lb·ft)

9. Refill the crankcase with the specified amount of engine oil, and then install the oil filler cap.

ECA10441

NOTICE

After changing the engine oil, be sure to check the oil pressure as described below.

10. Remove the bleed bolt, start the engine and keep it idling until oil flows out, then install the bleed bolt.

Periodic maintenance and adjustment

TIP _____

If no oil comes out after one to two minutes, stop the engine. Consult your Yamaha dealer for inspection before riding the vehicle again.

11. After checking the oil pressure, tighten the bleed bolt.

Tightening torque:

Bleed bolt:
7 N·m (0.7 kgf·m, 5.2 lb·ft)

12. Start the engine and let it idle for several minutes. Check for oil leakage.
13. Turn the engine off, and check the oil level one last time.

TIP _____

Be sure to wipe off spilled oil on any parts after the engine and exhaust system have cooled down.

Why Yamalube

YAMALUBE oil is a Genuine YAMAHA Part born of the engineers' passion and belief that engine oil is an important liquid engine component. We form teams of specialists in the fields of mechanical engineering, chemistry, electronics and track testing, and have them develop the engine together with the oil it will use. Yamalube oils take full advantage of the base oil's qualities and blend in the ideal balance of additives to make sure the final oil clears our performance standards. Thus, Yamalube mineral, semisynthetic and synthetic oils have their own distinct characters and value. Yamaha's experience gained over many years of research and development into oil since the 1960's helps make Yamalube the best choice for your Yamaha engine.



EAU85450

EAU81283

Replacing the air filter element and cleaning the check hoses

The air filter element should be replaced at the intervals specified in the periodic maintenance and lubrication chart. Replace the air filter element more frequently if you are riding in unusually wet or dusty areas. In addition, the air filter check hoses must be frequently checked and cleaned if necessary.

To replace the air filter element

1. Remove the air filter case cover by removing the screws.

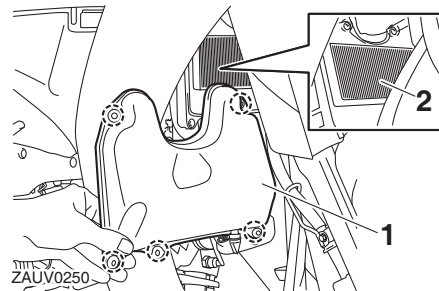

1. Air filter case cover
2. Air filter element

2. Pull the air filter element out.
3. Insert a new air filter element into the air filter case. **NOTICE: Make sure that the air filter element is properly seated in the air filter case. The engine should never be operated without the air filter element installed, otherwise the piston(s) and/or cylinder(s) may become excessively worn.**

[ECA10482]

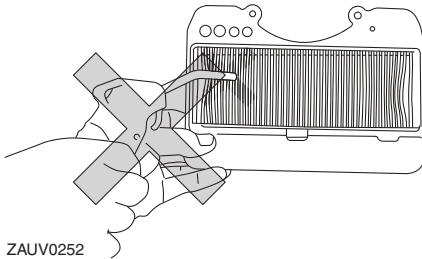

ZAUV0252

4. Install the air filter case cover by installing the screws.

To clean the air filter check hoses

1. Check the hoses shown for accumulated dirt, water or oil.

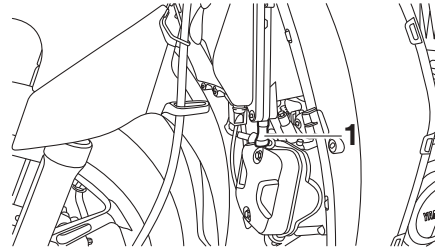

1. Air filter check hose
2. If dirt, water or oil is visible, remove the hose, clean it, and then install it in its original position.

Adjusting the engine idling speed

The engine idling speed must be checked and, if necessary, adjusted as follows at the intervals specified in the periodic maintenance and lubrication chart.

The engine should be warm before making this adjustment.

TIP

- The engine is warm when it quickly responds to the throttle.
- A diagnostic tachometer is needed to make this adjustment.

1. Attach the tachometer to the spark plug lead.
2. Check the engine idling speed and, if necessary, adjust it to specification by turning the throttle stop screw. To increase the engine idling speed, turn the screw in direction (a). To decrease the engine idling speed, turn the screw in direction (b).

Periodic maintenance and adjustment

EAU48434

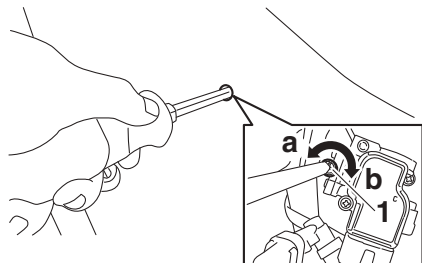

1. Idle adjusting screw

Engine idling speed:
1400–1600 r/min

TIP _____
8 If the specified idling speed cannot be obtained as described above, have a Yamaha dealer make the adjustment.

Adjusting the throttle grip free play

Measure the throttle grip free play as shown.

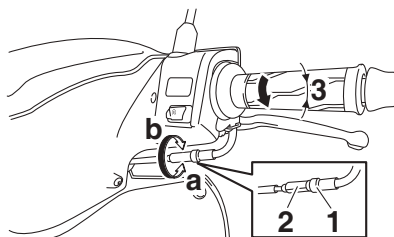

1. Locknut
2. Adjusting nut
3. Throttle grip free play

Throttle grip free play:
3.0–7.0 mm (0.12–0.28 in)

Periodically check the throttle grip free play and, if necessary, adjust it as follows.

TIP _____
The engine idling speed must be correctly adjusted before checking and adjusting the throttle grip free play.

1. Slide the rubber cover back.
2. Loosen the locknut.
3. To increase the throttle grip free play, turn the adjusting nut in direction (a). To decrease the throttle grip free play, turn the adjusting nut in direction (b).
4. Tighten the locknut and then slide the rubber cover to its original position.

EAU21403

EAU70052

Valve clearance

The valves are an important engine component, and since valve clearance changes with use, they must be checked and adjusted at the intervals specified in the periodic maintenance chart. Unadjusted valves can result in improper air-fuel mixture, engine noise, and eventually engine damage. To prevent this from occurring, have your Yamaha dealer check and adjust the valve clearance at regular intervals.

TIP

This service must be performed when the engine is cold.

Tires

Tires are the only contact between the vehicle and the road. Safety in all conditions of riding depends on a relatively small area of road contact. Therefore, it is essential to maintain the tires in good condition at all times and replace them at the appropriate time with the specified tires.

Tire air pressure

The tire air pressure should be checked and, if necessary, adjusted before each ride.

EWA10504

WARNING

Operation of this vehicle with improper tire pressure may cause severe injury or death from loss of control.

- The tire air pressure must be checked and adjusted on cold tires (i.e., when the temperature of the tires equals the ambient temperature).
- The tire air pressure must be adjusted in accordance with the riding speed and with the total

weight of rider, passenger, cargo, and accessories approved for this model.

Tire air pressure (measured on cold tires):

1 person:

Front:

200 kPa (2.00 kgf/cm², 29 psi)

Rear:

225 kPa (2.25 kgf/cm², 33 psi)

2 persons:

Front:

200 kPa (2.00 kgf/cm², 29 psi)

Rear:

280 kPa (2.80 kgf/cm², 41 psi)

Maximum load:

Vehicle:

154 kg (340 lb) (T115FL-2C,

T115FL-5CF)

155 kg (342 lb) (T115FL-5C)

The vehicle's maximum load is the combined weight of the rider, passenger, cargo, and any accessories.

EWA10512

WARNING

Never overload your vehicle. Operation of an overloaded vehicle could cause an accident.

Periodic maintenance and adjustment

Tire inspection

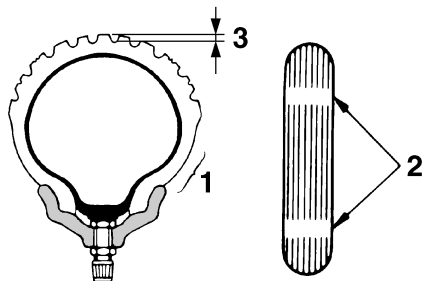

1. Tire sidewall
2. Tire wear indicator
3. Tire tread depth

The tires must be checked before each ride. If the tire shows crosswise lines (minimum tread depth), if the tire has a nail or glass fragments in it, or if the sidewall is cracked, have a Yamaha dealer replace the tire immediately.

Minimum tire tread depth (front and rear):
1.0 mm (0.04 in)

WARNING

EWA10563

- It is dangerous to ride with a worn-out tire. When a tire tread begins to show crosswise lines, have a Yamaha dealer replace the tire immediately.
- The replacement of all wheel and brake-related parts, including the tires, should be left to a Yamaha dealer, who has the necessary professional knowledge and experience.
- It is not recommended to patch a punctured tube. If unavoidable, however, patch the tube very carefully and replace it as soon as possible with a high-quality product.
- Ride at moderate speeds after changing a tire since the tire surface must first be “broken in” for it to develop its optimal characteristics.

Tire information

This model is equipped with tube tires.

Tires age, even if they have not been used or have only been used occasionally. Cracking of the tread and sidewall rubber, sometimes accompanied by carcass deformation, is an evidence of ageing. Old and aged tires shall be checked by tire specialists to ascertain their suitability for further use.

EWA10462

WARNING

The front and rear tires should be of the same make and design, otherwise the handling characteristics of the vehicle may be different, which could lead to an accident.

After extensive tests, only the tires listed below have been approved for this model by Yamaha.

Front tire:

Size:
70/90-17 M/C 38P
Manufacturer/model:
IRC/NF63B

Rear tire:

Size:
80/90-17 M/C 50P
Manufacturer/model:
IRC/NR78Y

Wheels

To maximize the performance, durability, and safe operation of your vehicle, note the following points.

- Check each wheel for cracks, deformation and other damage. If any damage is found, have the wheel inspected by your Yamaha dealer. Do not attempt to repair or straighten a bent or damaged wheel.
- For spoke wheel-equipped models, check the spokes for looseness. If any loose spokes are found, have the wheel adjusted by your Yamaha dealer. Improperly tightened spokes can cause wheel misalignment.
- Have the wheel balanced whenever the tire or tube has been replaced. An unbalanced wheel can result in adverse handling characteristics and shortened tire life.

EAU00293

EWA20560

WARNING

To avoid tire slippage and personal injury, use only the specified type of tire for each wheel.

Checking the brake lever free play

EAU37914

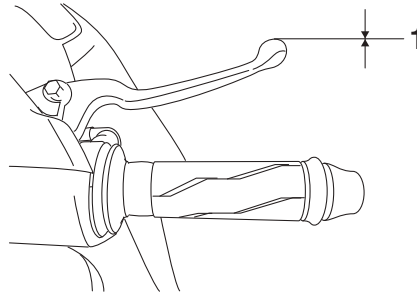

1. No brake lever free play

There should be no free play at the brake lever end. If there is free play, have a Yamaha dealer inspect the brake system.

EWA14212

WARNING

A soft or spongy feeling in the brake lever can indicate the presence of air in the hydraulic system. If there is air in the hydraulic system, have a Yamaha dealer bleed the system before operating the vehicle. Air in the hydraulic system will diminish the

braking performance, which may result in loss of control and an accident.

Periodic maintenance and adjustment

Adjusting the brake pedal free play

EAU39815

Measure the brake pedal free play at the brake pedal end as shown.

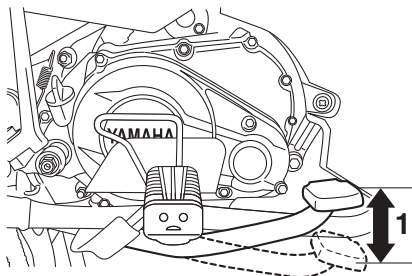

1. Brake pedal free play

Brake pedal free play:

8.0–18.0 mm (0.31–0.71 in)

Periodically check the brake pedal free play and, if necessary, adjust it as follows.

To increase the brake pedal free play, turn the brake pedal free play adjusting nut at the brake rod in direction (a). To decrease the brake pedal free play, turn the adjusting nut in direction (b).

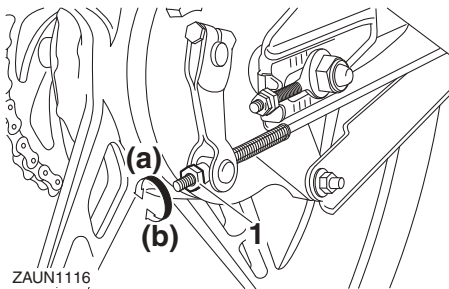

1. Brake pedal free play adjusting nut

EWA10681

WARNING

- After adjusting the drive chain slack or removing and installing the rear wheel, always check the brake pedal free play.
- If proper adjustment cannot be obtained as described, have a Yamaha dealer make this adjustment.
- After adjusting the brake pedal free play, check the operation of the brake light.

Brake light switches

EAU22275

The brake light is activated by switches connected to the brake lever and brake pedal. Check that the brake light comes on just before braking takes effect. If necessary, adjust the rear brake light switch as follows.

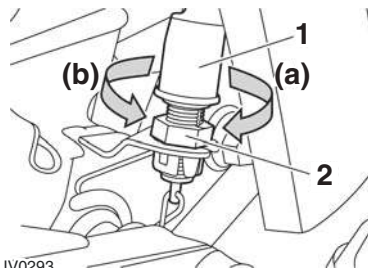

ZAUV0293

1. Rear brake light switch
2. Rear brake light switch adjusting nut

Turn the rear brake light switch adjusting nut while holding the rear brake light switch in place. To make the brake light come on earlier, turn the adjusting nut in direction (a). To make the brake light come on later, turn the adjusting nut in direction (b).

Periodic maintenance and adjustment

TIP _____
The front brake light switch should be serviced by a Yamaha dealer.

Checking the front brake pads and rear brake shoes

EAU22382

The front brake pads and the rear brake shoes must be checked for wear at the intervals specified in the periodic maintenance and lubrication chart.

Front brake pads

EAU22434

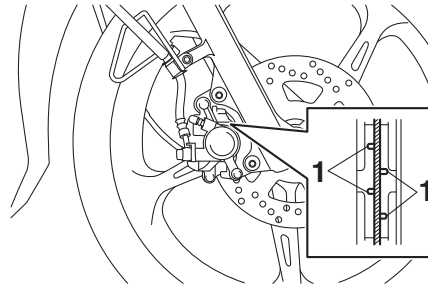

1. Brake pad wear indicator groove

Each front brake pad is provided with wear indicator grooves, which allow you to check the brake pad wear without having to disassemble the brake. To check the brake pad wear, check the wear indicator grooves. If a brake pad has worn to the point that the wear

indicator grooves have almost disappeared, have a Yamaha dealer replace the brake pads as a set.

Rear brake shoes

EAU22541

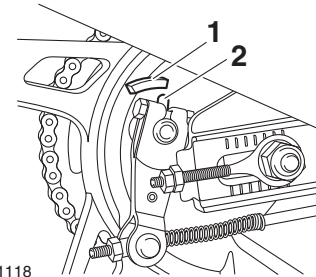

ZAUN1118

1. Brake shoe wear limit line
2. Brake shoe wear indicator

The rear brake is provided with a wear indicator, which allows you to check the brake shoe wear without having to disassemble the brake. To check the brake shoe wear, check the position of the wear indicator while applying the brake. If a brake shoe has worn to the point that the wear indicator reaches the wear limit line, have a Yamaha dealer replace the brake shoes as a set.

Periodic maintenance and adjustment

Checking the brake fluid level

EAUJ0831

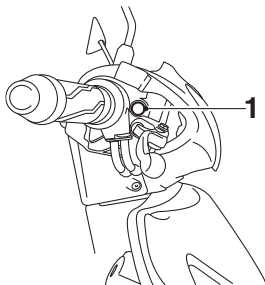

1. Minimum level mark

Insufficient brake fluid may allow air to enter the brake system, possibly causing it to become ineffective.

Before riding, check that the brake fluid is above the minimum level mark and replenish if necessary. A low brake fluid level may indicate worn brake pads and/or brake system leakage. If the brake fluid level is low, be sure to check the brake pads for wear and the brake system for leakage.

Observe these precautions:

- When checking the fluid level, make sure that the top of the master cylinder is level by turning the handlebars.

- Use only the recommended quality brake fluid, otherwise the rubber seals may deteriorate, causing leakage and poor braking performance.

Recommended brake fluid:

YAMAHA GENUINE BRAKE FLUID
or equivalent DOT3 or DOT4

- Refill with the same type of brake fluid. Mixing fluids may result in a harmful chemical reaction and lead to poor braking performance.
- Be careful that water does not enter the master cylinder when refilling. Water will significantly lower the boiling point of the fluid and may result in vapor lock.
- Brake fluid may deteriorate painted surfaces or plastic parts. Always clean up spilled fluid immediately.
- As the brake pads wear, it is normal for the brake fluid level to gradually go down. However, if the brake fluid level goes down suddenly, have a Yamaha dealer check the cause.

Changing the brake fluid

EAU22725

Have a Yamaha dealer change the brake fluid at the intervals specified in the periodic maintenance and lubrication chart. In addition, have the oil seals of the brake master cylinder and caliper as well as the brake hose replaced at the intervals listed below or whenever they are damaged or leaking.

- Brake seals: Replace every two years.
- Brake hose: Replace every four years.

Drive chain slack

EAU22762

The drive chain slack should be checked before each ride and adjusted if necessary.

To check the drive chain slack

EAU49265

1. Place the motorcycle on the side-stand or centerstand.

TIP

When checking and adjusting the drive chain slack, there should be no weight on the motorcycle.

2. Shift the transmission into the neutral position.
3. Remove the drive chain slack check hole cap.
4. Measure the drive chain slack as shown.

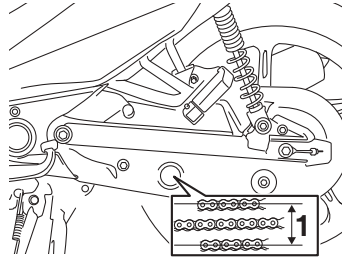

1. Drive chain slack

Drive chain slack:

30.0–40.0 mm (1.18–1.57 in)

5. If the drive chain slack is correct, install the check hole cap. If the drive chain slack is incorrect, adjust it as follows. **NOTICE: Improper drive chain slack will overload the engine as well as other vital parts of the motorcycle and can lead to chain slippage or breakage. To prevent this from occurring, keep the drive chain slack within the specified limits.** [ECA10572]

To adjust the drive chain slack

EAUV0462

Consult a Yamaha dealer before adjusting the drive chain slack.

1. Loosen the brake pedal free play adjusting nut and the brake torque rod nut.
2. Loosen the axle nut, then loosen the locknut at each end of the swingarm.

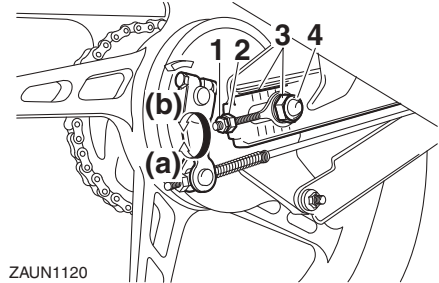

ZAUN1120

1. Locknut
2. Drive chain slack adjusting nut
3. Alignment marks
4. Axle nut

3. To tighten the drive chain, turn the drive chain slack adjusting nut at each end of the swingarm in direction (a). To loosen the drive chain, turn the adjusting nut at each end

Periodic maintenance and adjustment

EAU23018

of the swingarm in direction (b), and then push the rear wheel forward.

TIP _____
Using the alignment marks on each side of the swingarm, make sure that both drive chain pullers are in the same position for proper wheel alignment.

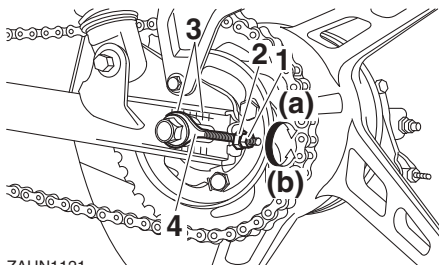

ZAUN1121

1. Locknut
 2. Drive chain slack adjusting nut
 3. Alignment marks
 4. Drive chain puller
4. Tighten both locknuts, and then tighten the axle nut and brake torque rod nut to their specified torques.

Tightening torques:

- Locknut:
7 N·m (0.7 kgf·m, 5.2 lb·ft)
Axle nut:
60 N·m (6.0 kgf·m, 44 lb·ft)
Brake torque rod nut:
19 N·m (1.9 kgf·m, 14 lb·ft)

TIP _____
When tightening the axle nut, hold the wheel axle with a wrench to keep it from turning.

5. Adjust the brake pedal free play. (See page 8-17.) **WARNING! After adjusting the brake pedal free play, check the operation of the brake light.** [EWA16081]
6. Make sure that the drive chain pullers are in the same position, the drive chain slack is correct, and the drive chain moves smoothly.
7. Install the drive chain slack check hole cap.

Cleaning and lubricating the drive chain

The drive chain must be cleaned and lubricated at the intervals specified in the periodic maintenance and lubrication chart, otherwise it will quickly wear out, especially when riding in dusty or wet areas. Service the drive chain as follows.

ECA10584

NOTICE _____

The drive chain must be lubricated after washing the motorcycle, riding in the rain or riding in wet areas.

1. Remove all dirt and mud from the drive chain with a brush or cloth.

TIP _____
For a thorough cleaning, have a Yamaha dealer remove the drive chain and soak it in solvent.

2. Spray Yamaha chain lubricant or other suitable chain lubricant on the entire chain, making sure that all side plates and rollers have been sufficiently oiled.

Periodic maintenance and adjustment

Checking and lubricating the cables

EAU23098

The operation of all control cables and the condition of the cables should be checked before each ride, and the cables and cable ends should be lubricated if necessary. If a cable is damaged or does not move smoothly, have a Yamaha dealer check or replace it. **WARNING! Damage to the outer housing of cables may result in internal rusting and cause interference with cable movement. Replace damaged cables as soon as possible to prevent unsafe conditions.** [EWA10712]

Recommended lubricant:

Yamaha cable lubricant or other suitable cable lubricant

Checking and lubricating the throttle grip and cable end

EAUE1191

The operation of the throttle grip should be checked before each ride. In addition, the cable end should be lubricated by a Yamaha dealer at the intervals specified in the periodic maintenance chart.

The throttle cable is equipped with a rubber cover. Make sure that the cover is securely installed. Even though the cover is installed correctly, it does not completely protect the cable from water entry. Therefore, use care not to pour water directly onto the cover or cable when washing the vehicle. If the cable or cover becomes dirty, wipe clean with a moist cloth.

Checking and lubricating the brake lever

EAU23155

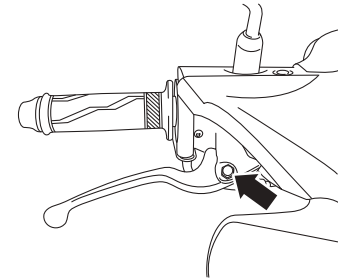

The operation of the brake lever should be checked before each ride, and the lever pivot should be lubricated if necessary.

Recommended lubricant:

Silicone grease

Periodic maintenance and adjustment

Checking and lubricating the brake pedal

EAU23185

The operation of the brake pedal should be checked before each ride, and the pedal pivot should be lubricated if necessary.

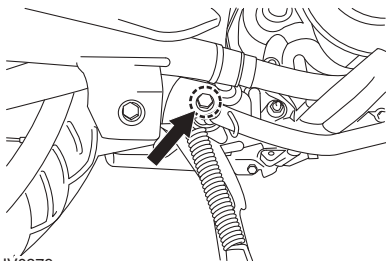

ZAUV0379

Recommended lubricant:
Lithium-soap-based grease

Checking and lubricating the centerstand and sidestand

EAU23215

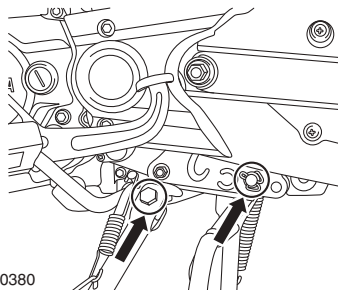

ZAUV0380

The operation of the centerstand and sidestand should be checked before each ride, and the pivots and metal-to-metal contact surfaces should be lubricated if necessary.

EWA10742

⚠ WARNING

If the centerstand or sidestand does not move up and down smoothly, have a Yamaha dealer check or repair it. Otherwise, the centerstand or sidestand could contact the ground and distract the operator, resulting in a possible loss of control.

Recommended lubricant:
Lithium-soap-based grease

EAUM1653

Lubricating the swingarm pivots

The swingarm pivots must be lubricated by a Yamaha dealer at the intervals specified in the periodic maintenance and lubrication chart.

Recommended lubricant:
Lithium-soap-based grease

EAU23273

Checking the front fork

The condition and operation of the front fork must be checked as follows at the intervals specified in the periodic maintenance and lubrication chart.

To check the condition

Check the inner tubes for scratches, damage and excessive oil leakage.

To check the operation

1. Place the vehicle on a level surface and hold it in an upright position. **WARNING! To avoid injury, securely support the vehicle so there is no danger of it falling over.** [EWA10752]
2. While applying the front brake, push down hard on the handlebars several times to check if the front fork compresses and rebounds smoothly.

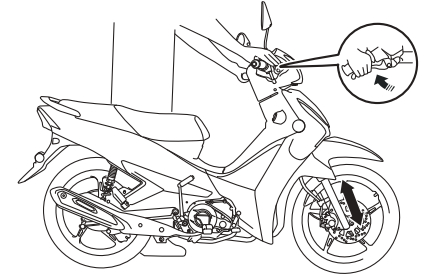

ECA10591

NOTICE

If any damage is found or the front fork does not operate smoothly, have a Yamaha dealer check or repair it.

Periodic maintenance and adjustment

EAU45512

Checking the steering

Worn or loose steering bearings may cause danger. Therefore, the operation of the steering must be checked as follows at the intervals specified in the periodic maintenance and lubrication chart.

1. Place the vehicle on the centerstand. **WARNING! To avoid injury, securely support the vehicle so there is no danger of it falling over.** [EWA10752]
2. Hold the lower ends of the front fork legs and try to move them forward and backward. If any free play can be felt, have a Yamaha dealer check or repair the steering.

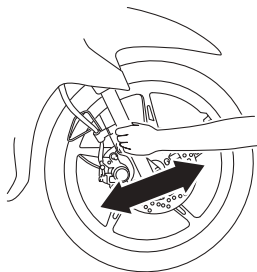

EAU23292

Checking the wheel bearings

The front and rear wheel bearings must be checked at the intervals specified in the periodic maintenance and lubrication chart. If there is play in the wheel hub or if the wheel does not turn smoothly, have a Yamaha dealer check the wheel bearings.

EAU2338A

Battery

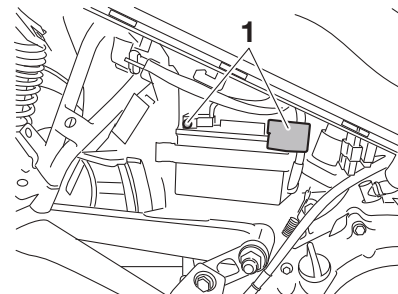

1. Battery terminals

The battery is located behind panel A. (See page 8-7.)

This model is equipped with a VRLA (Valve Regulated Lead Acid) battery. There is no need to check the electrolyte or to add distilled water. However, the battery lead connections need to be checked and, if necessary, tightened.

EWA10761

WARNING

- **Electrolyte is poisonous and dangerous since it contains sulfuric acid, which causes severe burns. Avoid any contact with skin, eyes or clothing and al-**

Periodic maintenance and adjustment

ways shield your eyes when working near batteries. In case of contact, administer the following **FIRST AID**.

- **EXTERNAL:** Flush with plenty of water.
- **INTERNAL:** Drink large quantities of water or milk and immediately call a physician.
- **EYES:** Flush with water for 15 minutes and seek prompt medical attention.
- Batteries produce explosive hydrogen gas. Therefore, keep sparks, flames, cigarettes, etc., away from the battery and provide sufficient ventilation when charging it in an enclosed space.
- **KEEP THIS AND ALL BATTERIES OUT OF THE REACH OF CHILDREN.**

ECA10621

NOTICE

Never attempt to remove the battery cell seals, as this would permanently damage the battery.

To charge the battery

Have a Yamaha dealer charge the battery as soon as possible if it seems to have discharged. Keep in mind that the battery tends to discharge more quickly if the vehicle is equipped with optional electrical accessories.

ECA16522

NOTICE

To charge a VRLA (Valve Regulated Lead Acid) battery, a special (constant-voltage) battery charger is required. Using a conventional battery charger will damage the battery.

To store the battery

1. If the vehicle will not be used for more than one month, remove the battery, fully charge it, and then place it in a cool, dry place.
NOTICE: When removing the battery, be sure to turn the main switch off, then disconnect the negative lead before disconnecting the positive lead.^[ECA16304]
2. If the battery will be stored for more than two months, check it at least once a month and fully charge it if necessary.

3. Fully charge the battery before installation. **NOTICE: When installing the battery, be sure to turn the main switch off, then connect the positive lead before connecting the negative lead.**

[ECA16842]

4. After installation, make sure that the battery leads are properly connected to the battery terminals.

ECA16531

NOTICE

Always keep the battery charged. Storing a discharged battery can cause permanent battery damage.

Periodic maintenance and adjustment

EAUU2580

Replacing the fuse

The fuse box, which contains the fuses for the individual circuit, is located beside the battery compartment behind panel A. (See page 8-7.)

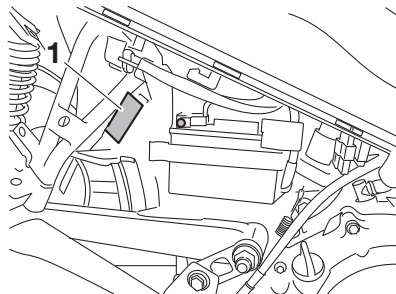

1. Fuse box

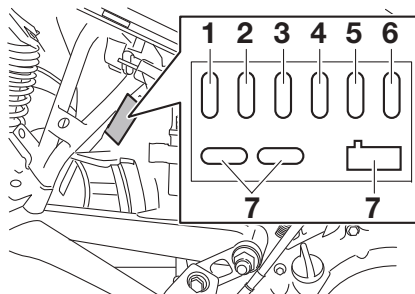

1. Main fuse
2. Backup fuse
3. Signal fuse
4. Headlight fuse
5. Terminal fuse
6. Ignition fuse
7. Spare fuse

If the fuse is blown, replace it as follows.

1. Turn the key to “OFF” and turn off all electrical circuits in question.
2. Removed panel A. (See page 8-7.)
3. Remove the blown fuse, and then install a new fuse of the specified amperage. **WARNING! Do not use a fuse of a higher amperage rating than recommended to**

avoid causing extensive damage to the electrical system and possibly a fire. [EWA15132]

Specified fuses:

- Main fuse:
15.0 A
- Backup fuse:
7.5 A
- Signaling system fuse :
7.5 A
- Ignition fuse :
7.5 A
- Headlight fuse:
7.5 A
- Terminal fuse:
5.0 A

4. Turn the key to “ON” and turn on the electrical circuits in question to check if the devices operate.
5. If the fuse immediately blows again, have a Yamaha dealer check the electrical system.

Headlight

EAU62851

This model is equipped with an LED-type headlight.

If a headlight does not come on, have a Yamaha dealer check its electrical circuit.

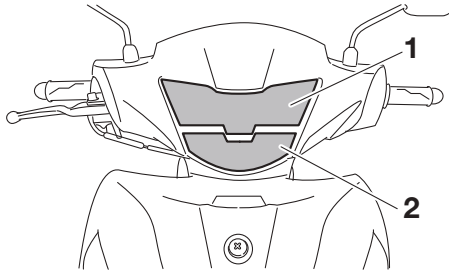

1. Headlight (low beam)
2. Headlight (high beam)

ECA16581

NOTICE

Do not affix any type of tinted film or stickers to the headlight lens.

Auxiliary light bulb

EAU39021

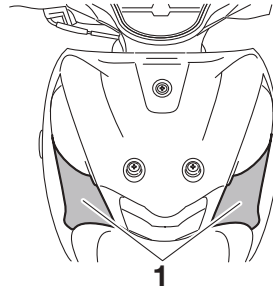

1. Auxiliary light

If the auxiliary light does not come on, have a Yamaha dealer check the electrical circuit or replace the bulb.

Front/rear turn signal light and tail/brake light

EAU1991

If a front/rear turn signal light or a tail/brake light does not come on, have a Yamaha dealer check its electrical circuit or replace the bulb.

Periodic maintenance and adjustment

EAU25853

Troubleshooting

Although Yamaha motorcycles receive a thorough inspection before shipment from the factory, trouble may occur during operation. Any problem in the fuel, compression, or ignition systems, for example, can cause poor starting and loss of power.

The following troubleshooting chart represents a quick and easy procedure for checking these vital systems yourself. However, should your motorcycle require any repair, take it to a Yamaha dealer, whose skilled technicians have the necessary tools, experience, and know-how to service the motorcycle properly.

Use only genuine Yamaha replacement parts. Imitation parts may look like Yamaha parts, but they are often inferior, have a shorter service life and can lead to expensive repair bills.

EWA15142



When checking the fuel system, do not smoke, and make sure there are no open flames or sparks in the area, including pilot lights from water

heaters or furnaces. Gasoline or gasoline vapors can ignite or explode, causing severe injury or property damage.

Troubleshooting chart

1. Fuel

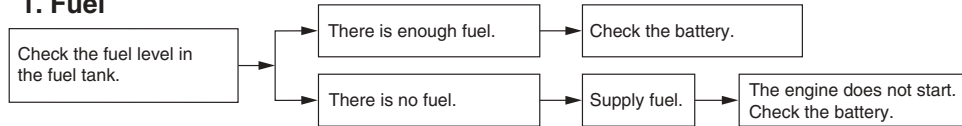

2. Battery

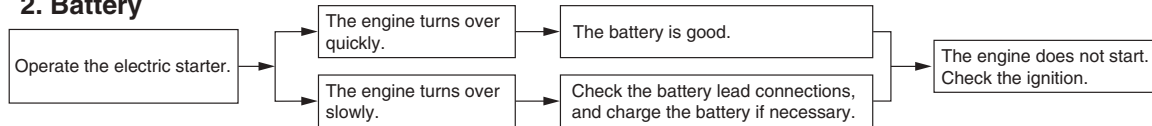

3. Ignition

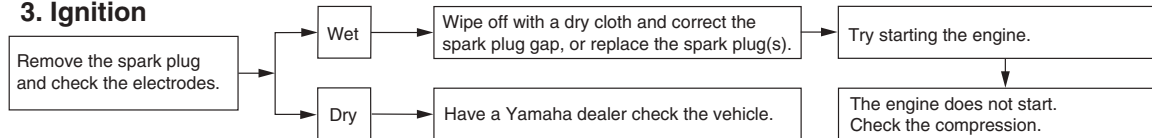

4. Compression

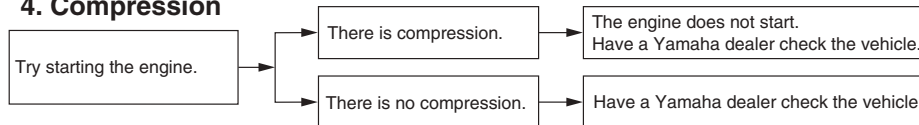

Periodic maintenance and adjustment

EAU76564

Emergency mode (T115FL-5CF)

When the smart key is lost or damaged, or its battery has discharged, the vehicle can still be turned on and the engine started. You will need the smart key system identification number.

To operate the vehicle in emergency mode

1. Stop the vehicle in a safe place and confirm the main switch is set to either “” or “OFF”.
2. Push the main switch knob for 5 seconds until the smart key system indicator light flashes once, then release it. Repeat two more times. The smart key system indicator light will come on for three seconds to indicate the transition to emergency mode.

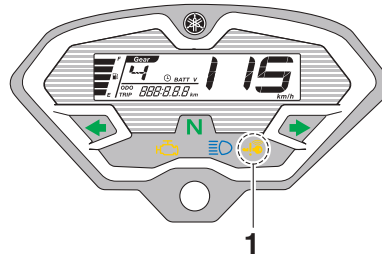

1. Smart key system indicator light “”

3. After the smart key system indicator light goes off, input the identification number as follows.

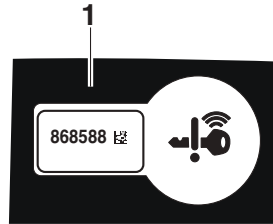

1. Identification number card

4. Inputting the identification number is done by counting the number of flashes of the smart key system indicator light.

For example, if the identification number is 123456:

Push and hold the knob.



The smart key system indicator light will start to flash.



Release the knob after the smart key system indicator light flashes once.



The first digit of the identification number has been set as “1”.



Push and hold the knob again.



Release the knob after the smart key system indicator light flashes twice.



The second digit has been set as “2”.



Repeat the above procedure until all digits of the identification number have been set. The smart key system indicator light will flash for 10 seconds if the correct identification number was entered.

TIP

When one of the following situations applies, emergency mode will be terminated and the smart key system indicator light will flash quickly for 3 seconds. In this case, start over again from step 2.

- When there are no knob operations for 10 seconds during the identification number input process.
- When the smart key system indicator light is allowed to flash nine or more times.

- The identification number is not entered correctly.
-

5. While the smart key system indicator light is on, push the knob once more to complete emergency mode access. The smart key indicator light will go off and then come back on for approximately 4 seconds.
6. While the smart key system indicator light is on, turn the main switch to “ON”. The vehicle can now be operated normally.

Motorcycle care and storage

Matte color caution

EAU37834

EAU0990

NOTICE

Some models are equipped with matte colored finished parts. Be sure to consult a Yamaha dealer for advice on what products to use before cleaning the vehicle. Using a brush, harsh chemical products or cleaning compounds when cleaning these parts will scratch or damage their surface. Wax also should not be applied to any matte colored finished parts.

ECA15193

Care

Frequent, thorough cleaning of the vehicle will not only enhance its appearance but also will improve its general performance and extend the useful life of many components. Washing, cleaning, and polishing will also give you a chance to inspect the condition of the vehicle more frequently. Be sure to wash the vehicle after riding in the rain or near the sea, because salt is corrosive to metals.

TIP

- Genuine Yamaha care and maintenance products are sold under the YAMALUBE brand in many markets worldwide.
- See your Yamaha dealer for additional cleaning tips.

ECA26280

NOTICE

Improper cleaning can cause cosmetic and mechanical damage. Do not use:

- high-pressure washers or steam-jet cleaners. Excessive water pressure may cause wa-

ter seepage and deterioration of wheel bearings, brakes, transmission seals and electrical devices. Avoid high-pressure detergent applications such as those available in coin-operated car washers.

- harsh chemicals, including strong acidic wheel cleaners, especially on spoke or magnesium wheels.
 - harsh chemicals, abrasive cleaning compounds, or wax on matte-finished parts. Brushes can scratch and damage the matte-finish, use soft sponge or towel only.
 - towels, sponges, or brushes contaminated with abrasive cleaning products or strong chemicals such as, solvents, gasoline, rust removers, brake fluid, or antifreeze, etc.
-

Before washing

1. Park the vehicle out of direct sunlight and allow it to cool. This will help avoid water spots.

2. Make sure all caps, covers, electrical couplers and connectors are tightly installed.
3. Cover the muffler end with a plastic bag and a strong rubber band.
4. Pre-soak stubborn stains like insects or bird droppings with a wet towel for a few minutes.
5. Remove road grime and oil stains with a quality degreasing agent and a plastic-bristle brush or sponge. **NOTICE: Do not use degreasing agent on areas requiring lubrication such as seals, gaskets, and wheel axles. Follow product instructions.**

[ECA26290]

Washing

1. Rinse off any degreaser and spray down the vehicle with a garden hose. Use only enough pressure to do the job. Avoid spraying water directly into the muffler, instrument panel, air inlet, or other inner areas such as underseat storage compartments.

2. Wash the vehicle with a quality automotive-type detergent mixed with cool water and a soft, clean towel or sponge. Use an old toothbrush or plastic-bristle brush for hard-to-reach places. **NOTICE: Use cold water if the vehicle has been exposed to salt. Warm water will increase salt's corrosive properties.** [ECA26301]
3. For windshield-equipped vehicles: Clean the windshield with a soft towel or sponge dampened with water and a pH neutral detergent. If necessary, use a high-quality windshield cleaner or polish for motorcycles. **NOTICE: Never use any strong chemicals to clean the windshield. Additionally, some cleaning compounds for plastic may scratch the windshield, so be sure to test all cleaning products before general application.** [ECA26310]
4. Rinse off thoroughly with clean water. Be sure to remove all detergent residues, as they can be harmful to plastic parts.

After washing

1. Dry the vehicle with a chamois or absorbent towel, preferably microfiber terrycloth.
2. For drive chain-equipped models: Dry and then lubricate the drive chain to prevent rust.
3. Use a chrome polish to shine chrome, aluminum, and stainless steel parts. Often the thermally induced discoloring of stainless steel exhaust systems can be removed through polishing.
4. Apply a corrosion protection spray on all metal parts including chrome or nickel-plated surfaces. **WARNING! Do not apply silicone or oil spray to seats, hand grips, rubber foot pegs or tire treads. Otherwise these parts will become slippery, which could cause loss of control. Thoroughly clean the surfaces of these parts before operating the vehicle.** [EWA20651]
5. Treat rubber, vinyl, and unpainted plastic parts with a suitable care product.

Motorcycle care and storage

6. Touch up minor paint damage caused by stones, etc.
7. Wax all painted surfaces using a non-abrasive wax or use a detail spray for motorcycles.
8. When finished cleaning, start the engine and let it idle for several minutes to help dry any remaining moisture.
9. If the headlight lens has fogged up, start the engine and turn on the headlight to help remove the moisture.
10. Let the vehicle dry completely before storing or covering it.

ECA26320

NOTICE

- Do not apply wax to rubber or unpainted plastic parts.
- Do not use abrasive polishing compounds as they will wear away the paint.
- Apply sprays and wax sparingly. Wipe off excess afterwards.

EWA20660

WARNING

Contaminants left on the brakes or tires can cause loss of control.

- **Make sure there is no lubricant or wax on the brakes or tires.**
 - **If necessary, wash the tires with warm water and a mild detergent.**
 - **If necessary, clean the brake discs and pads with brake cleaner or acetone.**
 - **Before riding at higher speeds, test the vehicle's braking performance and cornering behavior.**
-

EAU83472

Storage

Always store the vehicle in a cool, dry place. If necessary, protect it against dust with a porous cover. Be sure the engine and the exhaust system are cool before covering the vehicle. If the vehicle often sits for weeks at a time between uses, the use of a quality fuel stabilizer is recommended after each fill-up.

ECA21170

NOTICE

- **Storing the vehicle in a poorly ventilated room or covering it with a tarp, while it is still wet, will allow water and humidity to seep in and cause rust.**
 - **To prevent corrosion, avoid damp cellars, stables (because of the presence of ammonia) and areas where strong chemicals are stored.**
-

Long term storage

Before storing the vehicle long term (60 days or more):

Motorcycle care and storage

1. Make all necessary repairs and perform any outstanding maintenance.
2. Follow all instructions in the Care section of this chapter.
3. Fill up the fuel tank, adding fuel stabilizer according to product instructions. Run the engine for 5 minutes to distribute treated fuel through the fuel system.
4. For vehicles equipped with a fuel cock: Turn the fuel cock lever to the off position.
5. For vehicles with a carburetor: To prevent fuel deposits from building up, drain the fuel in the carburetor float chamber into a clean container. Retighten the drain bolt and pour the fuel back into the fuel tank.
6. Use a quality engine fogging oil according to product instructions to protect internal engine components from corrosion. If engine fogging oil is not available, perform the following steps for each cylinder:
 - a. Remove the spark plug cap and spark plug.
 - b. Pour a teaspoonful of engine oil into the spark plug bore.
 - c. Install the spark plug cap onto the spark plug, and then place the spark plug on the cylinder head so that the electrodes are grounded. (This will limit sparking during the next step.)
 - d. Turn the engine over several times with the starter. (This will coat the cylinder wall with oil.)
WARNING! To prevent damage or injury from sparking, make sure to ground the spark plug electrodes while turning the engine over.
[EWA10952]
 - e. Remove the spark plug cap from the spark plug, and then install the spark plug and the spark plug cap.
7. Lubricate all control cables, pivots, levers and pedals, as well as the sidestand and centerstand (if equipped).
8. Check and correct the tire air pressure, and then lift the vehicle so that all wheels are off the ground. Otherwise, turn the wheels a little once a month in order to prevent the tires from becoming degraded in one spot.
9. Cover the muffler outlet with a plastic bag to prevent moisture from entering it.
10. Remove the battery and fully charge it, or attach a maintenance charger to keep the battery optimally charged. **NOTICE: Confirm that the battery and its charger are compatible. Do not charge a VRLA battery with a conventional charger.** [ECA26330]

TIP

- If the battery will be removed, charge it once a month and store it in a temperate location between 0-30 °C (32-90 °F).
- See page 8-25 for more information on charging and storing the battery.

Specifications

Dimensions:

- Overall length:
1915 mm (75.4 in)
- Overall width:
710 mm (28.0 in)
- Overall height:
1100 mm (43.3 in)
- Seat height:
775 mm (30.5 in)
- Wheelbase:
1235 mm (48.6 in)
- Ground clearance:
155 mm (6.10 in)
- Minimum turning radius:
1.8 m (5.91 ft)

Weight:

- Curb weight:
100 kg (221 lb) (T115FL-5C)
99 kg (220 lb) (T115FL-2C, T115FL-5CF)

Engine:

- Combustion cycle:
4-stroke
- Cooling system:
Air cooled
- Valve train:
SOHC
- Number of cylinders:
Single cylinder
- Displacement:
114 cm³
- Bore × stroke:
50.0 × 57.9 mm (1.97 × 2.28 in)

Starting system:

- Electric starter (T115FL-5CF)
- Electric starter and kickstarter (T115FL-2C, T115FL-5C)

Engine oil:

Recommended brand:



SAE viscosity grades:

10W-40

Recommended engine oil grade:

API service SG type or higher, JASO standard MA

Engine oil quantity:

Oil change:

0.80 L (0.85 US qt, 0.70 Imp.qt)

With oil filter removal:

0.85 L (0.90 US qt, 0.75 Imp.qt)

Fuel:

Recommended fuel:

Unleaded gasoline (E10 to E20 only)

Octane number (RON):

90

Fuel tank capacity:

4.0 L (1.1 US gal, 0.9 Imp.gal)

Fuel injection:

Throttle body:

ID mark:

B7E

Drivetrain:

Gear ratio:

- 1st:
2.833 (34/12)
- 2nd:
1.875 (30/16)
- 3rd:
1.353 (23/17)
- 4th:
1.045 (23/22)

Front tire:

Type:

With tube

Size:

70/90-17 M/C 38P

Manufacturer/model:

IRC/NF63B

Rear tire:

Type:

With tube

Size:

80/90-17 M/C 50P

Manufacturer/model:

IRC/NR78Y

Loading:

Maximum load:

154 kg (340 lb) (T115FL-2C, T115FL-5CF)

155 kg (342 lb) (T115FL-5C)

(Total weight of rider, passenger, cargo and accessories)

Unified brake system:

Operation:

Activated by rear brake

Front brake:

Type:

Hydraulic single disc brake

Rear brake:

Type:

Mechanical leading trailing drum brake

Front suspension:

Type:

Telescopic fork

Rear suspension:

Type:

Swingarm

Electrical system:

System voltage:

12 V

Battery:

Model:

YTZ4V

Voltage, capacity:

12 V, 3.0 Ah (10 HR)

Bulb wattage:

Headlight:

LED

Brake/tail light:

21.0 W/5.0 W

Front turn signal light:

10.0 W

Rear turn signal light:

10.0 W

Auxiliary light:

5.0 W

Consumer information

EAU26366

Identification numbers

Record the vehicle identification number and the engine serial number in the spaces provided below for assistance when ordering spare parts from a Yamaha dealer or for reference in case the vehicle is stolen.

VEHICLE IDENTIFICATION NUMBER:

ENGINE SERIAL NUMBER:

Vehicle identification number

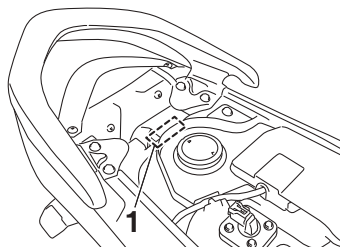

1. Vehicle identification number

The vehicle identification number is stamped into the frame.

TIP _____
The vehicle identification number is used to identify your vehicle and may be used to register it with the licensing authority in your area.

EAU26411

Engine serial number

EAU26442

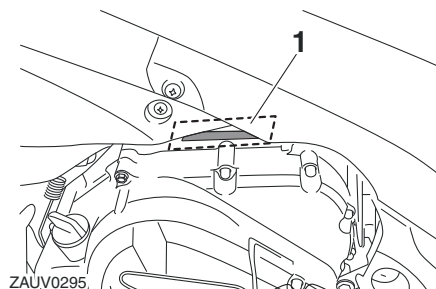

1. Engine serial number

The engine serial number is stamped into the crankcase.

Use of your data

This is a brief summary of how Yamaha (Yamaha Motor Co., Ltd., and the local subsidiaries) uses your data. For more details for Yamaha's use of your data, please see our Privacy Policy.

<https://global.yamaha-motor.com/en/privacy/>

What data we collect? and How we collect your data?

This vehicle collects three types of data through integrated Engine Control Units (ECU):

(1) Vehicle Identification Number (VIN); (2) live data showing the performance of the vehicle such as engine/motor operating state, vehicle speed, mileage; and (3) other data showing the status of the vehicle such as diagnostic trouble code (DTC). The collected data will be uploaded to server at Yamaha Motor Co., Ltd. by attaching a special Yamaha diagnostic tool to the vehicle, only when maintenance checks or service procedures are performed.

How will we use your data?

Yamaha use collected data from your vehicle, (1) to conduct adequate maintenance service including diagnostics, (2) to implement proper warranty claim judgement, (3) to conduct research and development of vehicle, (4) to provide and improve quality of products, features, and services, (5) to ensure our business purpose, and (6) to comply with legal obligations or lawful orders, and to establish or defend legal claims.

How we share your data?

We may share your data with: (i) our subsidiaries, affiliates, and business partners; (ii) dealers and distributors in your country or region, and (iii) contractors within the scope necessary to achieve the purpose of use described above.

How to contact us

Any questions or complaints regarding the processing of your Personal Data can be submitted in writing to the local subsidiaries.

<https://global.yamaha-motor.com/link/>

Consumer information

The **SOLE PURPOSE** of above provided contact information is **TO RESPOND DATA PROCESSING INQUIRY AND OTHER KINDS OF INQUIRIES WILL NOT BE RESPONDED**. Please provide the following information for the proper handling of your inquiry: **(1) Your Name; (2) Your Email Address; (3) Your Country of Residence; and (4) Your VIN**. We will use your personal information provided only for the purpose of supporting your data processing inquiry.

- A**
- Air filter element and check hoses, replacing and cleaning 8-11
 - Auxiliary light bulb 8-28
- B**
- Battery 8-25
 - Battery voltage warning light 5-6
 - Brake fluid, changing 8-19
 - Brake fluid level, checking 8-19
 - Brake lever 5-11
 - Brake lever, checking and lubricating 8-22
 - Brake lever free play, checking 8-16
 - Brake light switches 8-17
 - Brake pads and shoes, checking 8-18
 - Brake pedal 5-11
 - Brake pedal, checking and lubricating 8-23
 - Brake pedal free play, adjusting 8-17
- C**
- Cables, checking and lubricating 8-22
 - Care 9-1
 - Catalytic converter 5-13
 - Centerstand and sidestand, checking and lubricating 8-23
 - Clock 5-9
- D**
- Dimmer switch 5-10
 - Drive chain, cleaning and lubricating ... 8-21
 - Drive chain slack 8-20
- E**
- Emergency mode 8-31
 - Engine break-in 7-1
 - Engine idling speed 8-12
 - Engine oil and oil filter element 8-9
 - Engine serial number 11-1
 - Engine trouble warning light 5-6
- F**
- Front fork, checking 8-24
 - Front/rear turn signal light and tail/brake light 8-28
 - Fuel 5-12
 - Fuel consumption, tips for reducing 7-4
 - Fuel meter 5-7
 - Fuel tank cap 5-12
 - Fuse, replacing 8-27
- H**
- Handlebar switches 5-10
 - Headlight 8-28
 - Helmet holders 5-15
 - Helmets 2-6
 - High beam indicator light 5-6
 - Horn switch 5-10
- I**
- Identification numbers 11-1
 - Indicator lights and warning lights 5-6
- K**
- Keyhole cover 5-5
 - Kickstarter 5-14
- L**
- Labels, location 1-1
 - Luggage hook 5-17
- M**
- Main switch 5-1
 - Main switch/steering lock 5-4
 - Maintenance and lubrication, periodic 8-3
 - Maintenance, emission control system 8-2
 - Matte color, caution 9-1
 - Multi-function display 5-8
 - Multi-function meter unit 5-7
- N**
- Neutral indicator light 5-6
- O**
- Operating range of the smart key system 4-2
- P**
- Panel, removing and installing 8-7
 - Parking 7-4
 - Part locations 3-1
 - Power outlet 5-17
- S**
- Safe-riding points 2-5
 - Safety information 2-1
 - Seat 5-14
 - Shifting 7-3
 - Shift pedal 5-10
 - Sidestand 5-18
 - Smart key battery 4-4
 - Smart key system 4-1
 - Smart key system indicator light 5-6
 - Spark plug, checking 8-7
 - Specifications 10-1
 - Speedometer 5-7
 - Starting and warming up a cold engine 7-2
 - Start switch 5-10
 - Steering, checking 8-25
 - Storage 9-3
 - Storage compartments 5-15

Index

Swingarm pivots, lubricating8-24

T

Throttle grip and cable, checking

and lubricating8-22

Throttle grip free play, adjusting8-13

Tires8-14

Tool kit8-1

Transmission gear display5-8

Troubleshooting8-29

Troubleshooting chart8-30

Turn signal indicator lights5-6

Turn signal switch5-10

U

Use, your vehicle data11-2

V

Valve clearance8-14

Vehicle identification number11-1

W

Wheel bearings, checking8-25

Wheels8-16

Y

Yamalube8-11



PRINTED IN THAILAND
2026.01 (E)